

● ● ● ● ●
SOUTHWEST **SOLUTIONS** GROUP

We Make Space & People Work Better Together

Emergency Response Lab Furnishings Catalog



Products for Immediate Shipment



Table of Contents

Painted Steel Casework	4-14
Patriot Table Systems	15-22
Fume Hoods	23-28
Shelving Systems	29-35
Work Surfaces	36
Faucets	37-39
Service Valves	40
Eyewash	41
Drench Shower/Eyewash Stations	42
Pegboards	43
Sinks	44-45
Electrical Pedestals	46
Seating	47
Lab Furniture Accessories	48-51



Emergency Response Lab Furnishings Program

The ***INSTOCK*** Emergency Response Lab Furnishings Program is designed to quickly provide and install clinical workstations or general laboratory bench space. These furnishings can be used for ongoing relief efforts or for critical testing and manufacturing operations. We have a dedicated project management team available to immediately design and layout any lab space. Products ship in 7 days. Other lab furnishings are available as needed upon request.

Please contact us for assistance.



INSTOCK® Standard Product Features:

- Inset style casework
- Modular design allows for simple field conversion from inset to overlay, door and drawer re-configurations and hardware component changes
- Durable construction provides SEFA 8 Metal compliant load-bearing capacity for years of dependable usage
- Drawer suspension is 100 lb. full extension
- **INSTOCK** “Pearl White” color is a urethane powder coating that provides superior chemical and abrasion resistance
- Products are SEFA 8 tested and approved by an independent third party



Laboratory Product Solutions

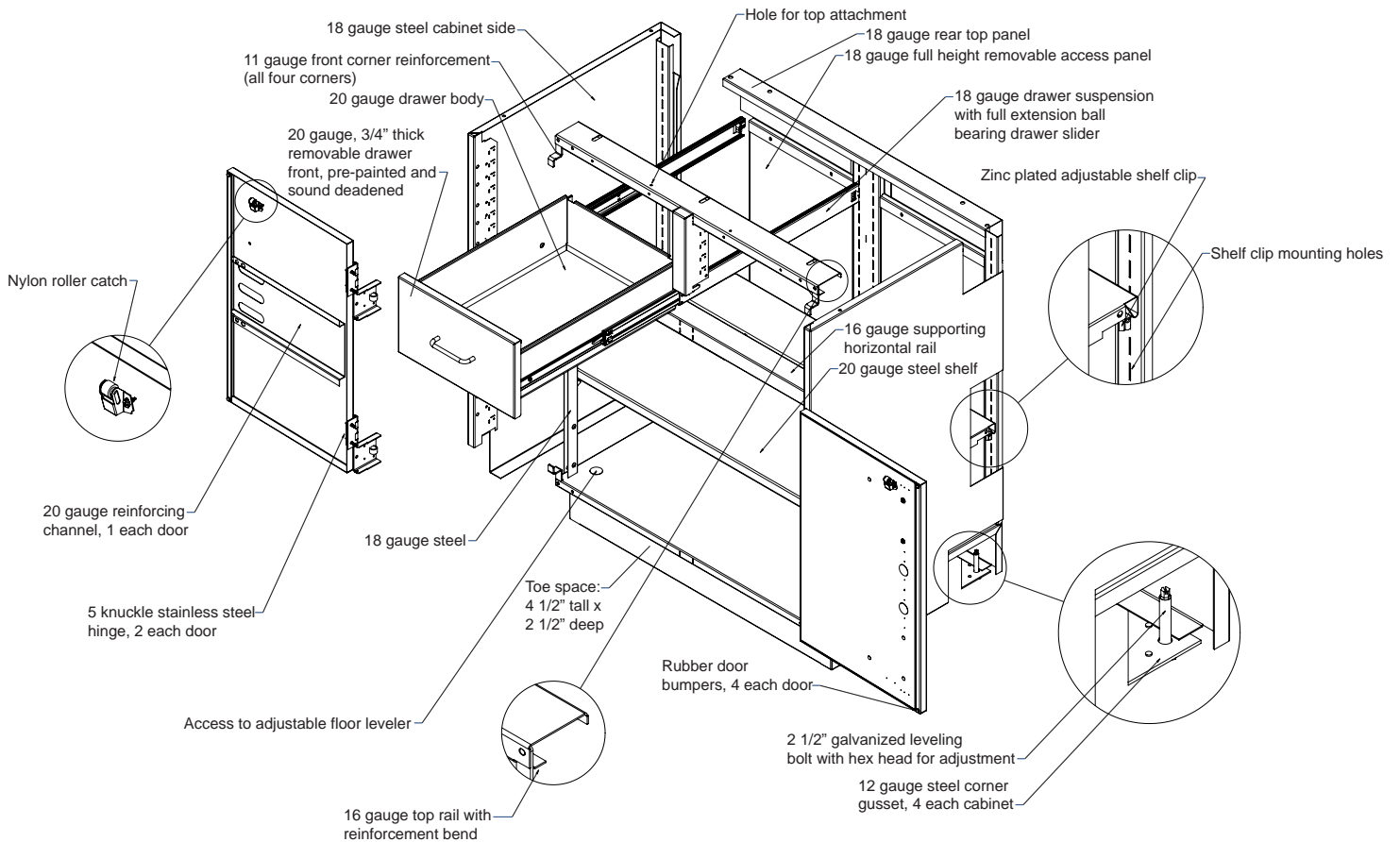

Design Appearance:

- Our quick delivery cabinetry is offered in a flush inset style. All cabinet component parts of the unit are manufactured ensuring uniformity, interchangeability and accurate alignment.

Color:

- Our quick delivery cabinetry is offered in a neutral color of Pearl White

Field Convertible:

- Field convertible design allows for conversion of cabinet door and drawer front styles, drawer body suspension and cabinet horizontal and vertical rails, with the use of simple hand tools.

LEED Compliance:

- Environmental compliant paints, glues and adhesives are specifically formulated to safeguard indoor air quality

Industry Compliance:

- SEFA 8 Metal, NFPA 30, UL listed and FM approved

Drawer Slide:

- 100 lbs. full extension, Standard

Standard Features:

- Stainless Steel Wire Pull
- Stainless Steel Five Knuckle Hinge
- Nylon Roller Door Catch

Door and Drawer Size Code

Mod Code	Height
Drawers	
3M	3.649" (9.3 cm)
4M	4.909" (12.5 cm)
6M	7.429" (18.9 cm)
8M	9.949" (25.3 cm)
9M	11.209" (28.5 cm)
10M	12.469" (31.7 cm)
Doors	
15M	18.769" (47.7 cm)
18M	22.549" (57.3 cm)
20M	25.069" (63.7 cm)
22M	27.589" (70.1 cm)
24M	30.109" (76.5 cm)
28M	35.149" (89.3 cm)
37M	47.749" (121.3 cm)
63M	79.249" (201.3 cm)

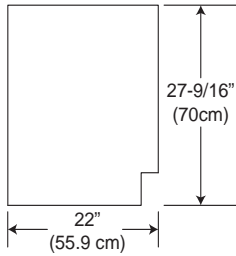

Sitting Height Base Cabinet

- Order work surfaces separately
- Provided without locks
- 27 9/16" (70 cm) Tall
- Standard Color: Pearl White
- All door and combination cabinets have a removable back
- All drawer cabinets have a cutout for service access

Door Cabinets

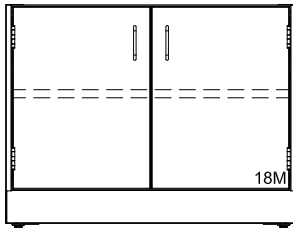

JTP163-36	36" W (91.4 cm)
-----------	-----------------

Drawer Cabinets

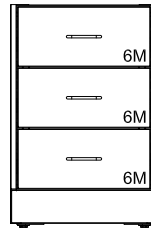

JTP174-18P	18" W (45.7 cm)
------------	-----------------

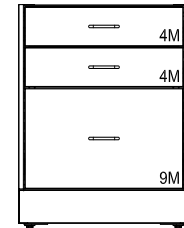

JTP070-24P	24" W (61 cm)
------------	---------------

Door and Drawer Cabinets

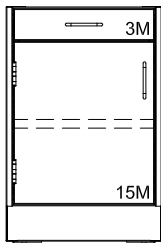

Left Hinged	
JTP169-18P	18" W (45.7 cm)

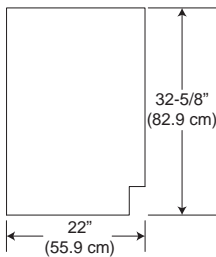

ADA Height Base Cabinet

- Order work surfaces separately
- Provided without locks
- 32 5/8" (82.9 cm) Tall
- Standard Color: Pearl White
- All door and combination cabinets have a removable back
- All drawer cabinets have a cutout for service access

Drawer Cabinets

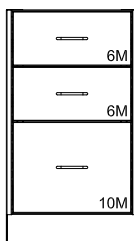

JTP925-18P	18" W (45.7 cm)
------------	-----------------

Sink Cabinet

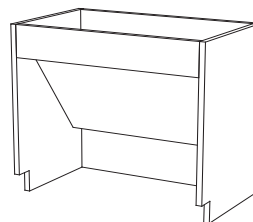

Assembly Required

JTP981ACC-36	36" W (91.4 cm)
--------------	-----------------

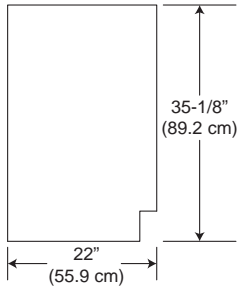

Standing Height Base Cabinet

- Order work surfaces separately
- Provided without locks
- 35 1/8" (89.2 cm) Tall
- Standard Color: Pearl White
- All door and combination cabinets have a removable back
- All drawer cabinets have a cutout for service access

Door Cabinets

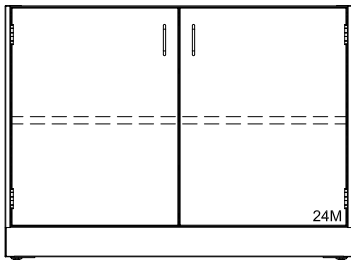

JTP103-30	30" W (76.2 cm)
JTP103-36	36" W (91.4 cm)
JTP103-48	48" W (121.9 cm)

Drawer Cabinets

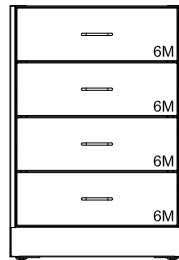

JTP122-18P	18" W (45.7 cm)
JTP122-24P	24" W (61 cm)

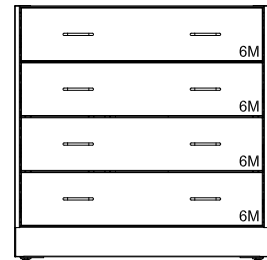

JTP121-36P	36" W (91.4 cm)
------------	-----------------

Drawer Cabinets

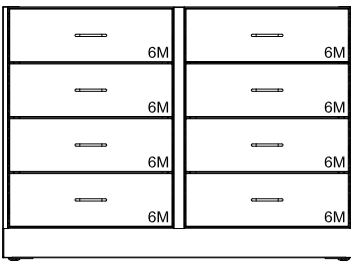

JTP124-48P	48" W (121.9 cm)
------------	------------------

Door/Drawer Cabinets

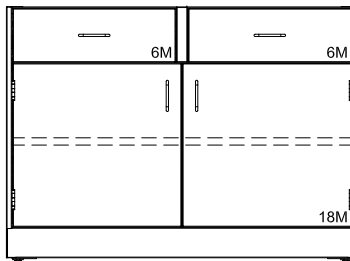

JTP106-36P	36" W (91.4 cm)
JTP106-42P	42" W (106.7 cm)
JTP106-48P	48" W (121.9 cm)

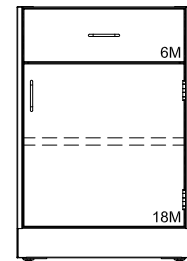

Right Hinged	
JTP118-18P	18" W (45.7 cm)
JTP118-24P	24" W (61 cm)
Left Hinged	
JTP119-18P	18" W (45.7 cm)
JTP119-24P	24" W (61 cm)

Corner/Sink Cabinet

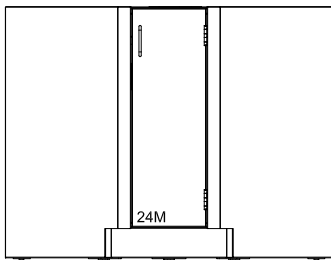

Right Hinged	
JTP190-32SE	32-7/8" W (83.5 cm)

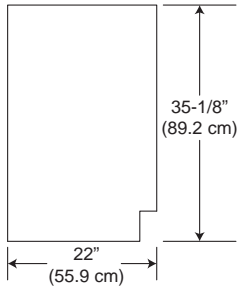

Standing Height Base Cabinet

- Order work surfaces separately
- Provided without locks
- 35 1/8" (89.2 cm) Tall
- Standard Color: Pearl White
- All door and combination cabinets have a removable back
- All drawer cabinets have a cutout for service access

Sink Cabinets

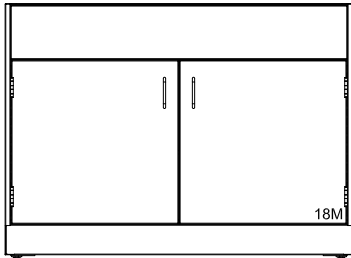

JTP181-36	36" W (91.4 cm)
JTP181-48	48" W (121.9 cm)

End Island Sink Cabinets

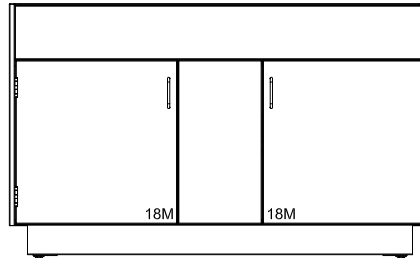

JTP186-52	52" W (132.1 cm)
JTP186-58	58" W (147.3 cm)

Sink Supports



JP535-36	36" W (91.4 cm)
JP535-48	48" W (121.9 cm)
JP535-52	52" W (132.1 cm)
JP535-58	58" W (147.3 cm)

Acid Storage Cabinets

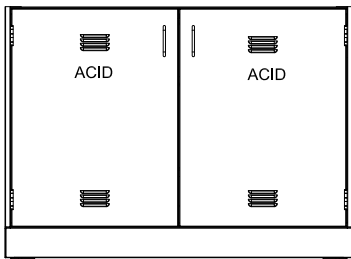

- Full-Height doors are lined with 1/8" thick polyethylene
- Chemical resistant 3/16" thick molded Polyethylene lining with coved corners and 2" lip at front of cabinet opening
- Includes vent kit
- One half-depth shelf

JTP185-24GG (Left Hinged)	24" W (61 cm)
JTP188-36GG	36" W (91.4 cm)
JTP188-48GG	48" W (121.9 cm)

Solvent Storage Cabinets

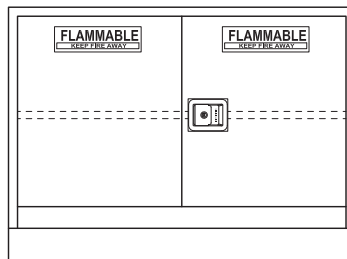

- Construction meets requirements listed by UFC, OSHA, and NFPA No. 30-1993
- Two 2" pipe threaded vent outlets on back
- Rear and top access panels
- Lock is included
- Self-closing

JTP189-24SLAS (Right Hinged)	24" W (61 cm)
JTP189-36SLASY	36" W (91.4 cm)
JTP189-48SLASY	48" W (121.9 cm)

Standard Hood Cabinets

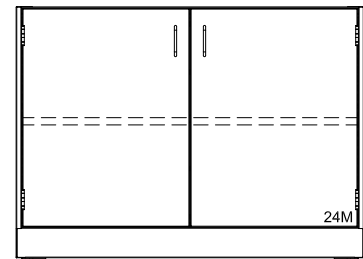

JTP103-30	30" W (76.2 cm)
JTP103-36	36" W (91.4 cm)
JTP103-48	48" W (121.9 cm)

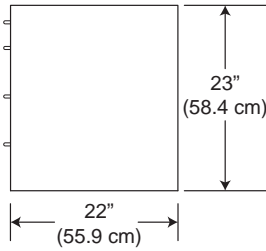

Suspended Cabinet

- 23" Tall and 22" Deep
- Standard Color: Pearl White
- Designed to be hung from an **INSTOCK** Patriot table
- Each suspended cabinet is furnished with complete hanging hardware.

Drawer Cabinets

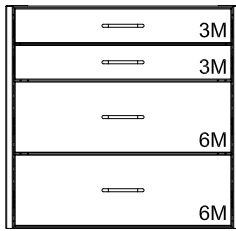

JTP820-18	18" W (45.7 cm)
JTP820-24	24" W (61 cm)

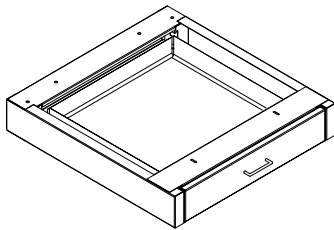

Suspended Pencil Drawer

- 3 7/8" Tall and 22" Deep
- Standard Color: Pearl White
- Designed to be hung from an **INSTOCK** Patriot table
- Each suspended cabinet is furnished with complete hanging hardware.

PPD1822	18" W (45.7 cm)
---------	-----------------

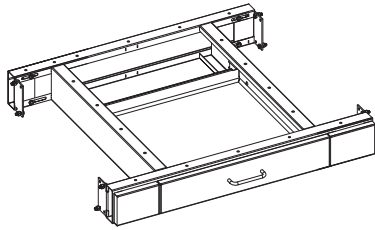

Apron Frame with Drawer

- Apron frame is 4" (11.4 cm) tall
- Use to span knee space area between two cabinets
- Attachment hardware included
- Standard color: Pearl White

Part Number	Width	Depth
JTPTBA-3022-1P	30" (76.2 cm)	22" (55.9 cm)
JTPTBA-3622-1P	36" (91.4 cm)	22" (55.9 cm)

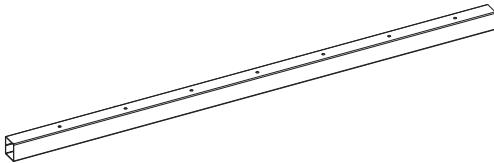

Apron Rail

- Apron rails are 2" tall and 2" deep
- Used to span and support knee space areas between two cabinets
- Attachment hardware is included
- Standard color: Pearl White
- Can be cut to fit in the field

Part Number	Width
JPTBR-3002	30" (76.2 cm)
JPTBR-3602	36" (91.4 cm)
JPTBR-4802	48" (121.9 cm)
JPTBR-7202	72" (182.9 cm)

Example use of Rails

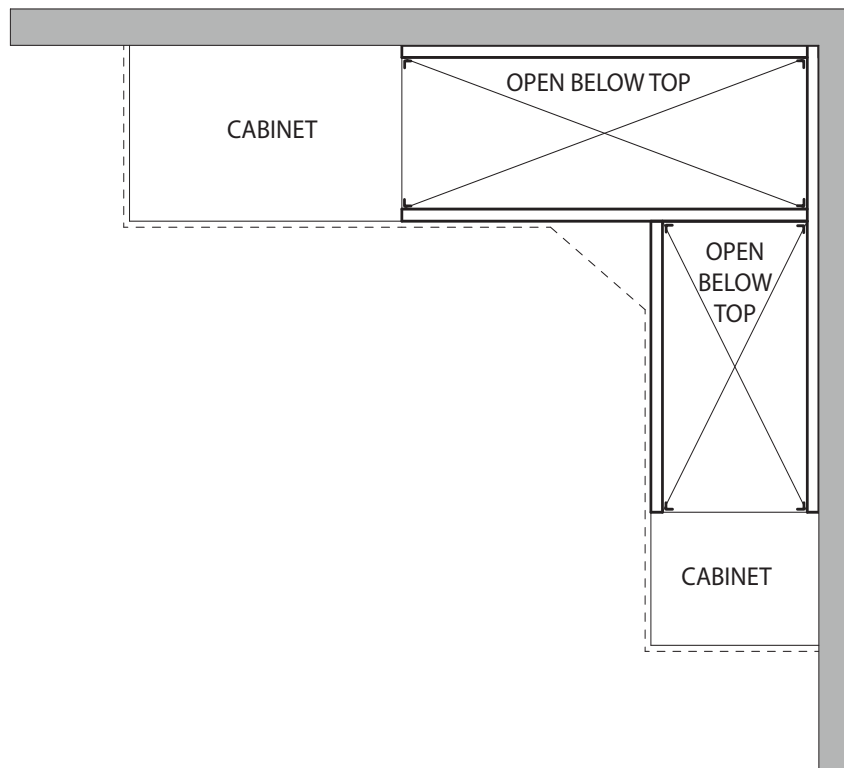

Panel End Supports

- Use in place of a cabinet at one end of a cabinet run to support drawer frames or apron rails
- Can be used to support the intersection of two aprons or rails
- Each panel has 2 leveling feet and is 2" (5.1 cm) wide
- Standard Color: Pearl White

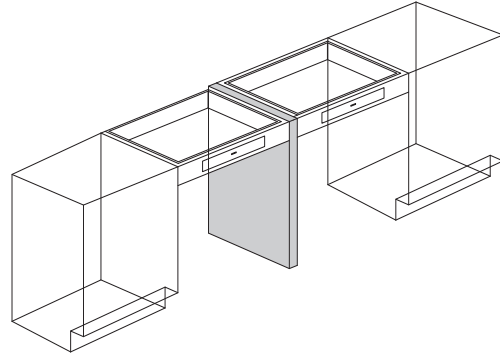
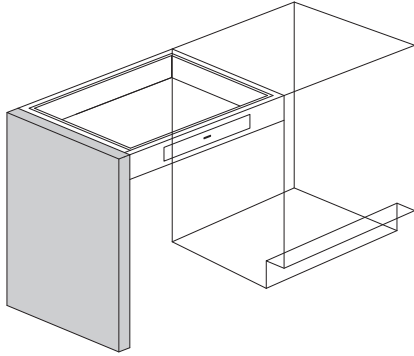

Part Number	Depth	Height
Sitting Height		
JPTPO-2822	22" (55.9 cm)	27 9/16" (70 cm)
ADA Height		
JPTPO-3222	22" (55.9 cm)	32 5/8" (82.8 cm)
Standing Height		
JPTPO-3522	22" (55.9 cm)	35 1/8" (89.2 cm)

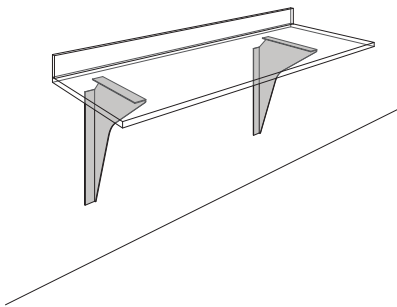

Heavy Duty Wall Mount Bracket Countertop Support

- Used to support spans of work surface without structure mounted on the floor
- Adequate in-wall blocking is required.
- 11 gauge bracket has a 2" wide return flanges with mounting holes at the top and rear of the bracket
- Bracket is 24" tall and can be mounted at any chosen height
- Standard color: Pearl White

Part Number	Depth
FF-CTOP-18	18" (45.7 cm)
FF-CTOP-23	23" (58.4 cm)

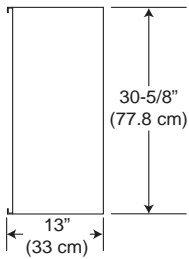

Wall Cabinets

- Provided without locks
- 30 5/8" (77.8 cm) Tall x 13" (33 cm) Deep
- Standard Color: Pearl White
- Two adjustable shelves
- Flush Bottom

Solid Door Wall Cabinets

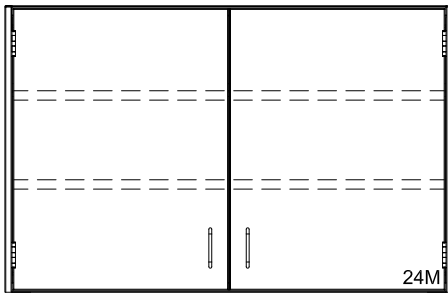

JTP203-36	36" W (91.4 cm)
JTP203-48	48" W (121.9 cm)

Framed Glass Wall Cabinets

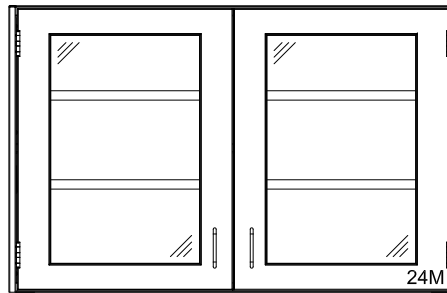

JTP206-36	36" W (91.4 cm)
JTP206-48	48" W (121.9 cm)

Rear Wall Cabinet Filler

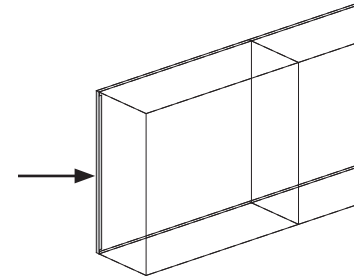

JC1392N0124P

Steel Solid Door Tall Cabinet

- Standard without locks
- Five shelves are included and are adjustable in half-inch increments
- Must be anchored to wall
- 84-5/16" Tall x 22" Deep
- Standard Color: Pearl White

Solid Door Tall Cabinets

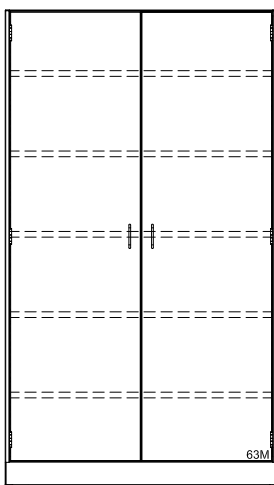

JTP303-36	36" W (91.4 cm)
JTP303-48	48" W (121.9 cm)

Steel Glass Door Tall Cabinet

- Standard with locks
- Five shelves are included and are adjustable in half-inch increments
- Must be anchored to wall
- 84-5/16" Tall x 22" Deep
- Standard Color: Pearl White

Framed Glass Door Tall Cabinets

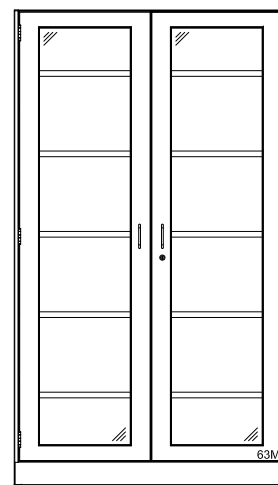

JTP307-36L	36" W (91.4 cm)
JTP307-48L	48" W (121.9 cm)

Knee Space Panels for use with Drawer Aprons

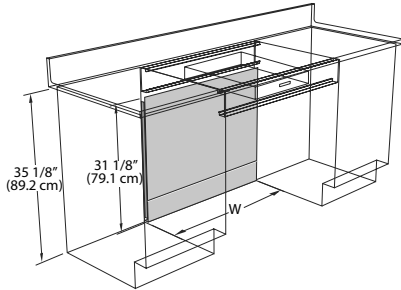

Part Number	Width
Standing Height	
JKSH-3004GG	30" (76.2 cm)
JKSH-3604GG	36" (91.4 cm)

Knee Space Panels for use with 2" High Apron Rails

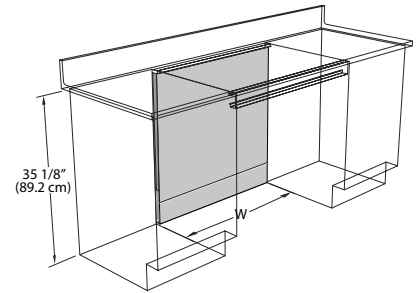
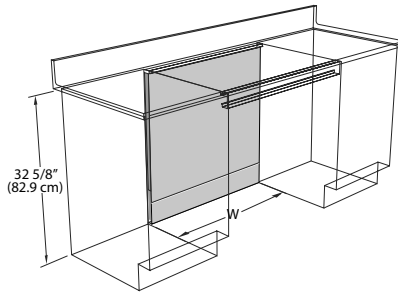
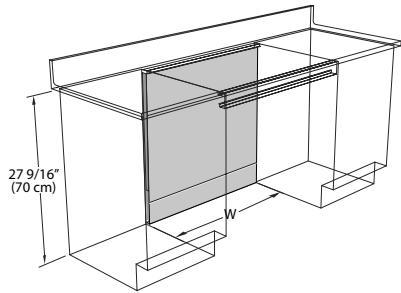

Part Number	Width
Sitting Height	
JKSL-ADJGG*	ADJUSTABLE 12"-48" (30.5 - 121.9 cm)

Part Number	Width
ADA Height	
JKSA-ADJGG*	ADJUSTABLE 12"-48" (30.5 - 121.9 cm)

Part Number	Width
Standing Height	
JKSH-30GG	30" (76.2 cm)
JKSH-36GG	36" (91.4 cm)
JKSH-ADJGG*	ADJUSTABLE 12"-48" (30.5 - 121.9 cm)
JKSH-72ADJGG*	ADJUSTABLE 12"-72" (30.5 - 182.9 cm)

* Cut to fit and includes slip fit trim angle

Corner Fillers

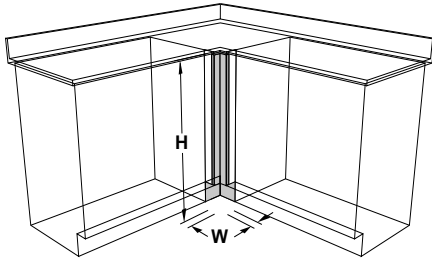

Part Number	Width
Standing Height - 35 1/8"	
JFCH-01	1" (2.5 cm)
JFCH-ADJ*	ADJUSTABLE 2"-12" (5.1 - 30.5 cm)

* Cut to fit and includes slip fit trim angle

Front Fillers Panels

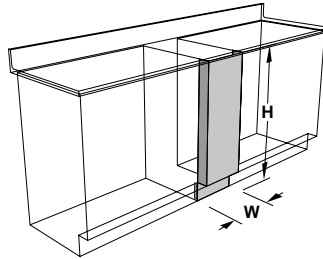

- For use between adjacent base cabinets or between a cabinet and the wall

Part Number	Width
Sitting Height - 27 9/16"	
JFFL-ADJ*	2"-18" (5.1 - 45.7 cm)
Standing Height - 35 1/8"	
JFFH-01	1" (2.5 cm)
JFFH-04	4" (10.2 cm)
JFFH-08	8" (20.3 cm)
JFFH-ADJ*	2"-18" (5.1 - 45.7 cm)

Rear and Center Fillers Panels

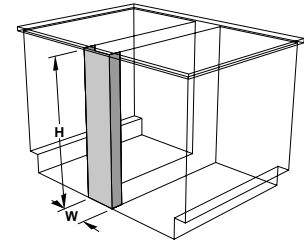

- For use between back-to-back base cabinets or to close space at the rear of the cabinet

Part Number	Width
Sitting Height - 27 9/16"	
JFRL-07	7" (18.7 cm)
ADA Height - 32 5/8"	
JFRA-07	7" (18.7 cm)
Standing Height - 35 1/8"	
JFRH-01	1" (3.5 cm)
JFRH-07	7" (18.7 cm)
JFRH-08	8" (21.3 cm)
JFRH-14	14" (36.5 cm)
JFRH-ADJ*	2" - 18" (5.1 - 45.7 cm)

Pipe Enclosures - Steel

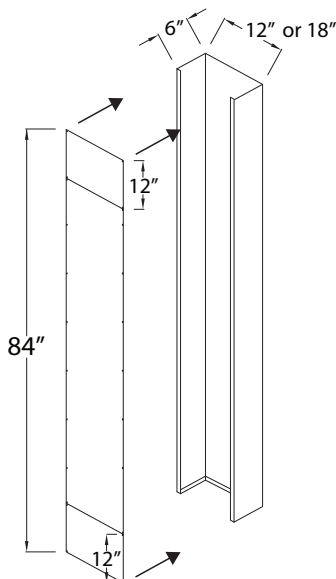

- Used to provide a cover for pipes running from the ceiling to the work surface
- Can be used for island or perimeter locations
- Can support pegboards or water purification systems
- Cover is pre-punched for attachment and is furnished in three sections for ease of access after installation

Part Number	Dimensions (W x D x H)
JP509-1284	12" x 6" x 84" (30.5 x 15.2 x 212.1 cm)
JP509-1884	18" x 6" x 84" (45.7 x 15.2 x 212.1 cm)



Our Patriot Table is a value driven, adjustable height, standard duty bench suitable for many basic lab applications. They are available with and without shelving uprights.

Adjustable Height Patriot Table with Leveling Glides



- Includes leveling glides that have a 1/2" stem and 1 3/4" foot
- Tables have a mechanical bolt style height adjustment
- Work surface is 1" thick black phenolic or Tyle 304 #4 finish stainless steel
- 1" work surface overhang on front and sides, 1 5/8" work surface overhang on back
- Steel frame color: Pearl White
- All adjustable height benches with leveling glides are rated for 950 lbs. UDL.

Part Number	Dimensions W x D x H
Phenolic Work Surface	
PT4830-LG	48" x 30" x 30"-36" (121.9 x 76.2 x 76.2-91.4 cm)
PT6030-LG	60" x 30" x 30"-36" (152.4 x 76.2 x 76.2-91.4 cm)
PT7230-LG	72" x 30" x 30"-36" (182.9 x 76.2 x 76.2-91.4 cm)
Stainles Steel Work Surface	
PS4830-LG	48" x 30" x 30"-36" (121.9 x 76.2 x 76.2-91.4 cm)
PS6030-LG	60" x 30" x 30"-36" (152.4 x 76.2 x 76.2-91.4 cm)
PS7230-LG	72" x 30" x 30"-36" (182.9 x 76.2 x 76.2-91.4 cm)

Note: Tables with stainless steel work surfaces ship in 5 weeks.

Adjustable Height Patriot Table with Locking Swivel Casters



- Include 4" locking swivel casters
- Tables have a mechanical bolt style height adjustment
- Work surface is 1" thick black phenolic or Tyle 304 #4 finish stainless steel
- 1" work surface overhang on front and sides, 1 5/8" work surface overhang on back
- Steel frame color: Pearl White
- All adjustable height benches with leveling glides are rated for 950 lbs. UDL.

Part Number	Dimensions W x D x H
Phenolic Work Surface	
PT4830-C	48" x 30" x 30"-36" (121.9 x 76.2 x 76.2-91.4 cm)
PT6030-C	60" x 30" x 30"-36" (152.4 x 76.2 x 76.2-91.4 cm)
PT7230-C	72" x 30" x 30"-36" (182.9 x 76.2 x 76.2-91.4 cm)
Stainles Steel Work Surface	
PS4830-C	48" x 30" x 30"-36" (121.9 x 76.2 x 76.2-91.4 cm)
PS6030-C	60" x 30" x 30"-36" (152.4 x 76.2 x 76.2-91.4 cm)
PS7230-C	72" x 30" x 30"-36" (182.9 x 76.2 x 76.2-91.4 cm)

Note: Tables with stainless steel work surfaces ship in 5 weeks.

Adjustable Height Patriot Table with Leveling Glides, Uprights and One 12” Deep Steel Shelf



- Includes leveling glides that have a 1/2” stem and 1 3/4” foot.
- Benches have a mechanical bolt style height adjustment.
- Work surface is 1” black phenolic.
- Steel shelf includes a front and rear lip and bookend brackets.
- Steel frame color: Pearl White
- All adjustable height benches with leveling glides are rated for 950 lbs. UDL.

Part Number	Dimensions W x D x H
PT4830-ULG	48” x 30” x 30”-36” (121.9 x 76.2 x 76.2-91.4 cm)
PT6030-ULG	60” x 30” x 30”-36” (152.4 x 76.2 x 76.2-91.4 cm)
PT7230-ULG	72” x 30” x 30”-36” (182.9 x 76.2 x 76.2-91.4 cm)

Adjustable Height Patriot Table with Locking Swivel Casters, Uprights and One 12” Deep Steel Shelf



- Includes 4” locking swivel casters
- Benches have a mechanical bolt style height adjustment.
- Work surface is 1” black phenolic.
- Steel shelf includes a front and rear lip and bookend brackets.
- Steel frame color: Pearl White
- All adjustable height benches with leveling glides are rated for 950 lbs. UDL.

Part Number	Dimensions W x D x H
PT4830-UC	48” x 30” x 30”-36” (121.9 x 76.2 x 76.2-91.4 cm)
PT6030-UC	60” x 30” x 30”-36” (152.4 x 76.2 x 76.2-91.4 cm)
PT7230-UC	72” x 30” x 30”-36” (182.9 x 76.2 x 76.2-91.4 cm)

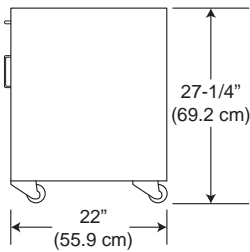

Mobile Cabinet

- Order work surfaces separately
- Provided without locks
- 27 1/4" Tall and 22" Deep
- Standard Color: Pearl White
- Cabinets include 4 each heavy duty 3" casters, the front 2 casters are locking
- Drawer interlock system included and counter weighted anti-tip design.

Combination Cabinets

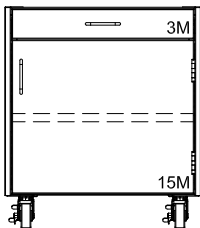

Drawer Cabinets

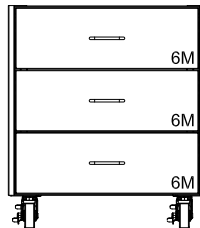

Right Hinged	
JTP1068-18	18" W (45.7 cm)
JTP1068-24	24" W (61 cm)

JTP1072-18	18" W (45.7 cm)
JTP1072-24	24" W (61 cm)

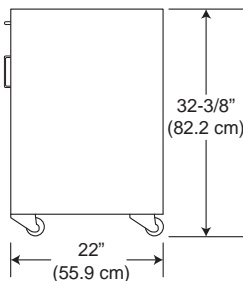

Mobile Cabinet

- Order work surfaces separately
- Provided without locks
- 32 3/8" Tall and 22" Deep
- Standard Color: Pearl White
- Cabinets include 4 each heavy duty 3" casters, the front 2 casters are locking
- Drawer interlock system included and counter weighted anti-tip design.

Combination Cabinets

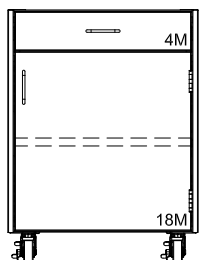

Drawer Cabinets

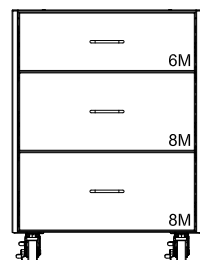

Right Hinged	
JTP1018-18	18" W (45.7 cm)
JTP1018-24	24" W (61 cm)

JTP1021-18	18" W (45.7 cm)
JTP1021-24	24" W (61 cm)

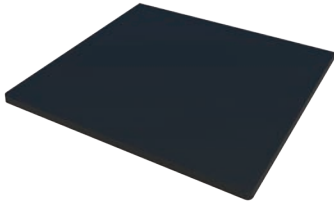

Mobile Cabinet Work Surface

- Work surface is 3/4" thick black phenolic resin that provide a 1" overhang on the front and a 1/2" overhang at the rear and sides.
- It adds 3/4" to the overall height of the cabinet.
- There is a grip notch included under the front edge of the work surface to help maneuver cabinet

Part Number	For use with:
MWS-18	18" (45.7 cm) wide mobile cabinet
MWS-24	24" (61 cm) wide mobile cabinet

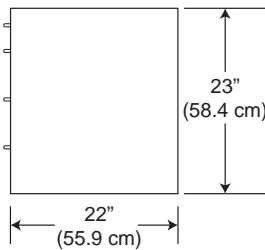

Suspended Cabinet

- 23" Tall and 22" Deep
- Standard Color: Pearl White
- Designed to be hung from an **INSTOCK®** Patriot table
- Each suspended cabinet is furnished with complete hanging hardware.

Drawer Cabinets

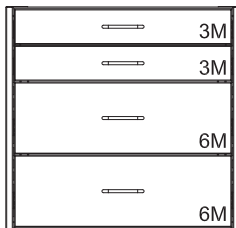

JTP820-18	18" W (45.7 cm)
JTP820-24	24" W (61 cm)

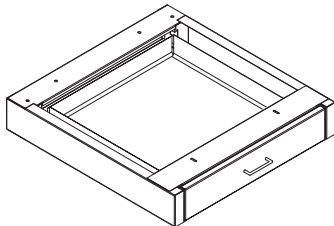

PPD1822	18" W (45.7 cm)
---------	-----------------

Suspended Pencil Drawer

- 3 7/8" Tall and 22" Deep
- Standard Color: Pearl White
- Designed to be hung from an **INSTOCK** Patriot table
- Each suspended cabinet is furnished with complete hanging hardware.

Additional 12" Deep Shelf and Brackets



- Includes a painted steel shelf with bookend brackets, front and rear lip and all attachment hardware.
- To be used with Patriot Table with Uprights.
- Standard color: Pearl White

Part Number	For Use with
PT48-AS	48" wide Patriot Table
PT60-AS	60" wide Patriot Table
PT72-AS	72" wide Patriot Table

LED Task Lighting Assemblies for Patriot Table with Uprights



- Features multiple, state of the art, energy saving components that include touch and hold continuous dimming and 10-hour automatic turnoff.
- 4', 5' and 6' tables include 1 ea. LED task light, magnetic angle mount that allows for up to 25 degrees of adjustment, 60 watt power supply with magnetic mount and 6' white cord.
- Made with anodized aluminum and lasts up to 50,000 hours.

Part Number	Actual Width	For Use with
PT48-LED	30.1" (76.5 cm)	48" wide Patriot Table
PT60-LED	43.7" (111 cm)	60" wide Patriot Table
PT72-LED	57.9" (147.1 cm)	72" wide Patriot Table

Electrical Outlet Strip and Bin Rail



- Bin rails with electric outlet strips are furnished with all hardware for attachment to Patriot Table with uprights.
- All electrical outlet strips are 24" long and include 20 amp wiring, 8 each 20 amp outlets and a 20 amp circuit breaker
- They include a 6' cord with a 20 amp NEMA 5-20P plug.
- Also available with a NEMA L5-20P plug allowing the work bench to connect to a twist-to-lock receptacle on an over head service panel.
- Rail will accept standard AkroMils Bins

Standard 20 amp plug	Twist-to-Lock 20 amp plug	Bin Rail Length	Number of Outlets
PT48-ESBRS	PT48-ESBRT	48" (121.9 cm)	8
PT60-ESBRS	PT60-ESBRT	60" (152.4 cm)	8
PT72-ESBRS	PT72-ESBRT	72" (182.9 cm)	8

Bracket for Plumbing Service Fixtures

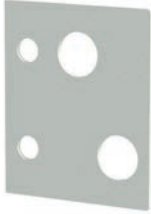

- To be used with the Patriot Table with uprights.
- The painted steel bracket can be used on the left or right upright of the table and is bored to accept 2 plumbing fixtures.
- Standard color: Pearl White

Part Number	For use with
PTBSF	Patriot Table with Uprights

Overhead Service Panel



- These painted steel overhead service panels are designed to fit into a 24" x 24" ceiling grid.
- They are made to order based upon services required.
- Components are sold separately and are shipped loose to be installed on site.
- Standard color: Pearl White

Part Number	Number of Service Cutouts
ENOSP-10	1-10
ENOSP-20	11-20

Twist-to-Lock Electrical for Overhead Service Panel

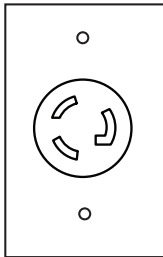

- Includes electrical box, NEMA L5-20R, 120 V, 20 amp twist-to-lock receptacle, and a stainless steel cover plate.

Part Number	NEMA Configuration
EN-LEV5-20R	L5-20R

Patriot Table Complete Plumbing Assemblies



System Service Hose



Male Quick Connect Plug

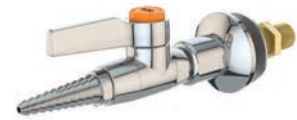

Ball Valve Service Turret

Patriot Table Complete Plumbing Assemblies include a ball valve service turret with shank, a service hose, and a male quick connect fitting. These complete assemblies are designed specifically for use with out workstations in a laboratory environment. All quick connects have 316 stainless steel internal components. Keyed quick connect members will only couple with components of the same key which are identified by a color code. Assemblies consist of 2 major components and are shipped loose to be installed on site.

The service hoses carry services from the overhead service panel, through the upright of the table and to the shank of the fixture. They consist of color coded reinforced PVC 1/4" hose. Air and Nitrogen male quick connects have double end shut off plugs and have an internal valve that shuts off flow when un-coupled. Vacuum has a single end shut off plug and does not have an internal valve. The ball valve is a polished chrome valve with a brass floating cone and integral brass seat. They provide metering control of laboratory gases at pressures up to 60 PSI. The turret shank is bored for the connection of the service hose.

Part Number	Color	Service
PTCPA-A	Orange	Air
PTCPA-V	Yellow	Vacuum
PTCPA-N	Brown	Nitrogen

Female Quick Connect Fitting



- These female quick connect fittings mount within the overhead service panel and provide the attachment point for the quick connect fittings from the workstation system to the building services.
- All fittings include 3/8" stems and hardware to be attached to the overhead service panel.
- All fitting types are keyed to ensure that they couple only with one of the same service.

Part Number	Color	Service
PSQC-A	Orange	Air
PSQC-V	Yellow	Vacuum
PSQC-N	Brown	Nitrogen

Hood Design Options to Fit Most Any Need

Our fume hood offering includes:

- True One Finger Sash Operation
- Easy Maintenance & Long Product Life Cycle
- UL 1805 Listed
- 3-Year Warranty
- Lifetime Warranty on Chain & Sprocket Sash Mechanism



Selecting a Complete Fume Hood

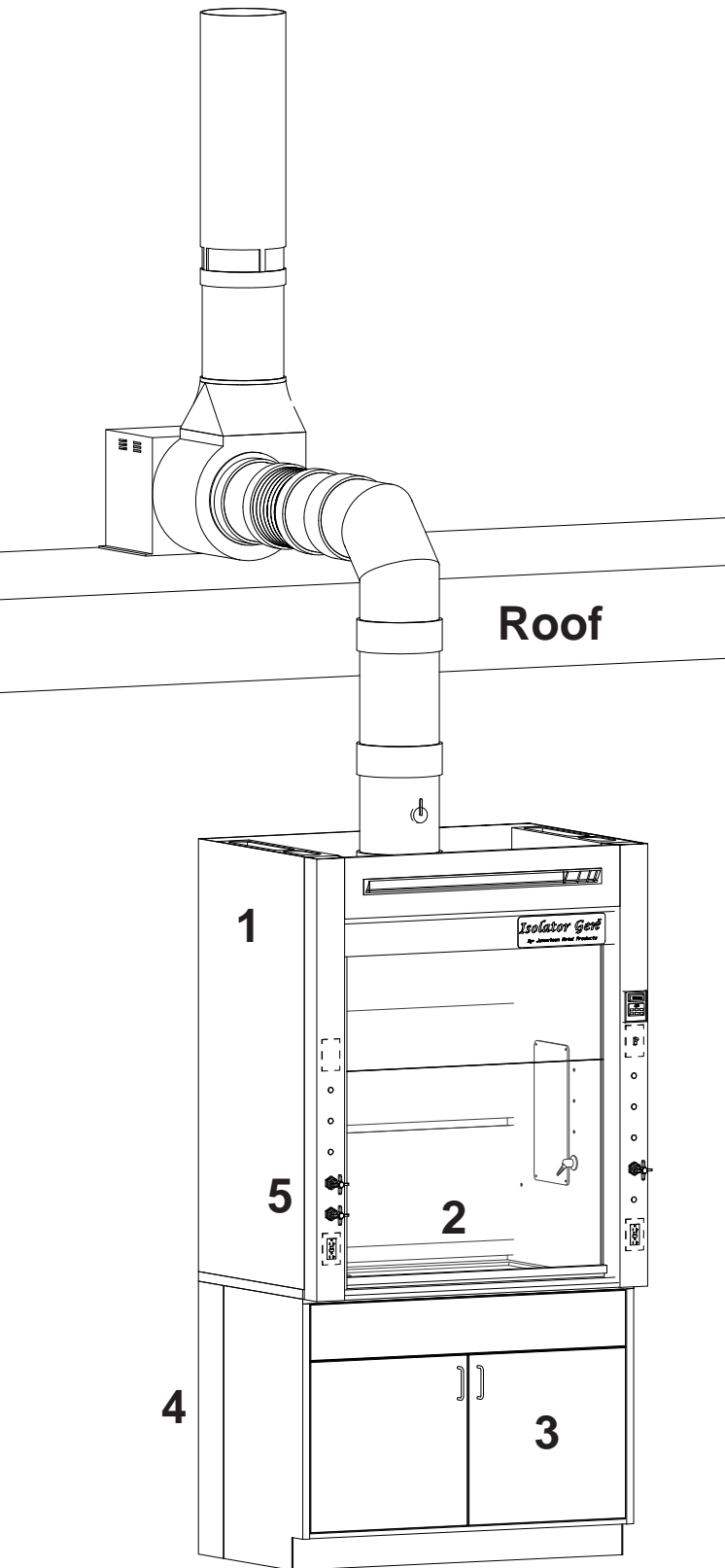

1. Select the Fume Hood Style and Size

General Purpose Bench Hood

4 ft. 5 ft. 6 ft.

General Purpose Walk-In Hood - Standard Depth

4 ft. 5 ft. 6 ft. 8 ft.

General Purpose Walk-In Hood - Extra Deep

4 ft. 5 ft. 6 ft. 8 ft.

2. Select a Work Surface and Sink

Standard Work Surface

4 ft. 5 ft. 6 ft.

Work Surface with Cup Sink

4 ft. 5 ft. 6 ft.

Sink Location

Left Right Both

3. Select Base Storage Cabinets

Steel Cabinets

General Acid Storage Solvent Storage

Wood Cabinets

General Acid Storage Solvent Storage

4. Select Cabinet and Hood Trim

Steel Cabinet Trim

Ceiling Enclosure

5. Select Service Fittings

Standard Fittings

Air Gas Vac CW Nitrogen

CW Gooseneck

Airflow Alarm Electrical



Full width sash weight at rear of hood



Heavy duty chain and sprocket sash mechanism with an exclusive lifetime warranty

Pre-wired outlet for available alarm



Integral stainless steel 12" (30.5 cm) round duct transition



Exclusive 43 1/2" (110.5 cm) tall "full view" sash area

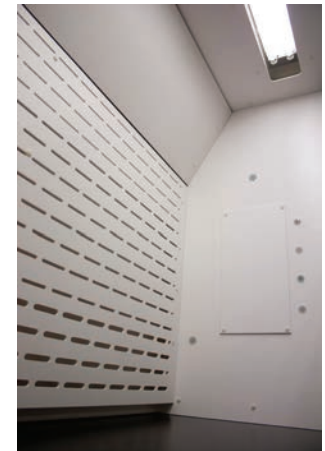

High performance baffle design, which can be used in both low and standard volume applications



Hood post and interior is punched to receive 5 service fixtures and a fan switch

Acid cabinets are furnished with a chemical resistant lining that has a 1 1/2" (3.8 cm) spill lip. Exhaust vent kit is included.



Full range of standard and specialty storage base cabinets



Hood is fully pre wired with two GFCI duplex outlets, light fixture, light switch and outlet on the roof

High Performance Fume Hood



Features:

- 24" (61 cm) deep clear interior
- Low static rectangular exhaust duct
- Integral stainless steel 12" (30.5 cm) round duct transition
- Slotted rear baffle for even plenum balance
- Safe operation at 60 fpm
- Chemically resistant white Poly glass liner
- UL1805 listed, ANSI/ASHRAE 110-1995, UL1275
- Three year hood superstructure warranty
- Chain & Sprocket sash mechanism with the exclusive lifetime warranty
- Exclusive standard 43 1/2" (110.5 cm) tall full view sash area
- Easy conversion from VAV to CAV
- Tempered glass sash with full-length formed steel handle for a neat, clean appearance and streamline air passage
- Standard Color: Pearl White
- Two pre-wired 120V 20 amp GFCI duplex receptacles
- One pre-wired 20 amp light switch
- Pre-wired vapor tight T8 fluorescent light fixture
- Each hood side post and interior is punched and plugged to receive 5 service fixtures
- Upper left side post is punched for optional fan switch
- One pre-wired outlet on roof of hood for an optional alarm
- Upper right side post is punched for optional alarm

Isolator ³ Part Number with frame less vertical sash	Overall Hood Width	Sash Opening Area (Sq Ft)	Total CFM & Static Pressure			
			24" (61 cm) Vertical Opening @ 60 FPM Face Velocity	S.P. Loss	18" (45.7 cm) Vertical Opening @ 80 FPM Face Velocity	S.P. Loss
F-350-48G7	4'-0" (121.9 cm)	6.3	380 CFM	0.21"	380 CFM	0.12"
F-350-60G7	5'-0" (152.4 cm)	8.3	500 CFM	0.20"	500 CFM	0.11"
F-350-72G7	6'-0" (182.9 cm)	10.3	620 CFM	0.31"	620 CFM	0.17"

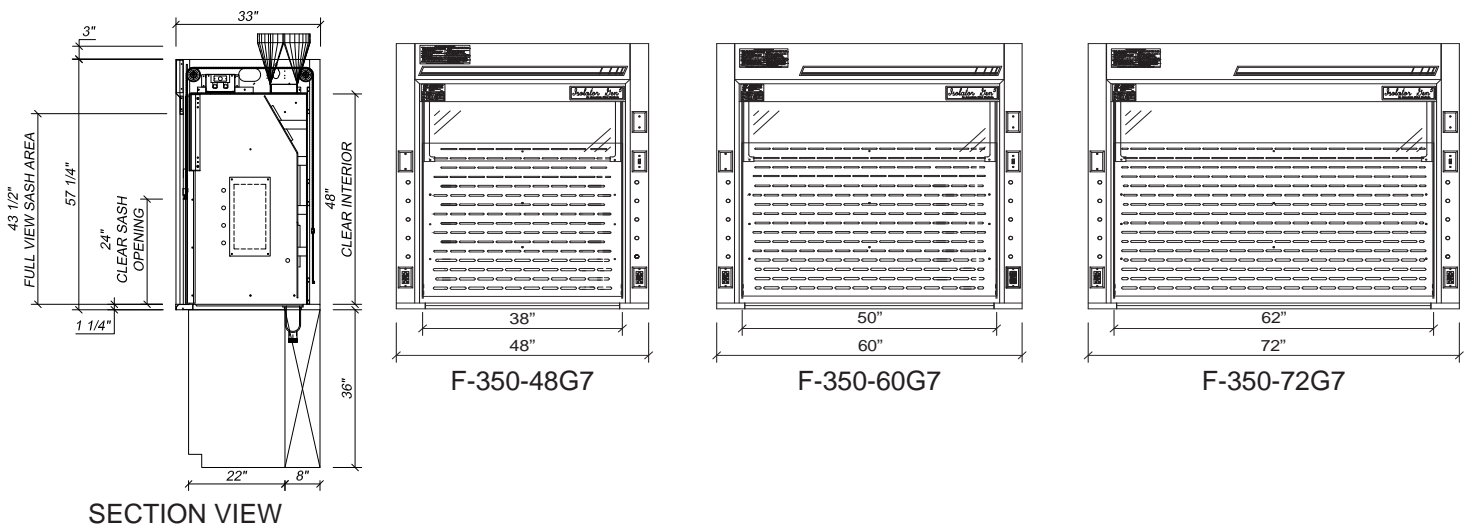

Fittings for Fume Hood

- These WaterSaver brand remote control fittings consist of a brass angle valve with a replaceable seat, an epoxy coated brass nylon color-coded panel flange with angle serrated hose connector, a remote control rod assembly with a plastic flange and a tank nipple, locknut and washer.
- Fittings may be used on either side of hood.
- Shipped loose and installed in field.



Fitting Type	Part Number
Air (Orange)	L3185N-LR-A
Gas (Dark Blue)	L3185N-LR-G
Nitrogen (Brown)	L3185N-LR-N
Vacuum (Yellow)	L3185N-LR-V

Cold Water Fitting for Fume Hood

- These WaterSaver brand remote control fittings consist of a brass angle valve with a replaceable seat, and epoxy coated brass nylon color-coded panel flange with a gooseneck with a vacuum breaker, a remote control rod assembly with a plastic flange and a tank nipple, locknut and washer.
- Shipped loose and installed in field.



Fitting Type	Part Number
Cold Water with Vacuum Breaker	L3185W-9RSVB

Fume Hood Alarm

- Each **INSTOCK**® fume hood is pre-punched for the fast and easy installation of this alarm.
- The monitor provides a digital readout of fume hood face velocity and sounds an alarm when the airflow falls below safe levels.
- Consisting of a thermostat sensor (mounted through the side wall of the fume hood) and a monitor (mounted on the fascia), the unit gives both a visual and audible alarm.
- The monitor also contains test/reset button allowing the user to verify alarm readiness.
- This monitor is shipped loose for field installation.



Product	Part Number
Fume Hood Alarm	AFA4000

External Vacuum Breaker

- Shipped loose and installed in field.



Fitting Type	Part Number
External Vacuum Breaker	L112WSA

Cold Water Fitting for Fume Hood

- These WaterSaver brand remote control fittings consist of a brass angle valve with a replaceable seat, and epoxy coated brass nylon color-coded panel flange with a gooseneck without a vacuum breaker, a remote control rod assembly with a plastic flange and a tank nipple, locknut and washer.
- Shipped loose and installed in field.



Fitting Type	Part Number
Cold Water without Vacuum Breaker	L3185W-9RS

Fan Blower Switch

- Manual fan motor starter switch, toggle style, single pole, with red pilot light, stainless steel cover plate, 1 thermal unit, for 1 or 2 HP maximum motor size

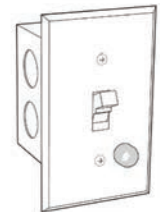

Product	Part Number
For use with a 1 HP fan	2510FS1P
For use with a 2 HP fan	2510FS2P

Bench Fume Hood Work Surface

- These 1 1/4" thick modified black epoxy resin work surfaces are required for all bench hoods and are dished to retain spills
- Sinks and cutouts are furnished as options

Bench Fume Hood Width	Part Number
4'-0" (121.9 cm)	WL-48B
5'-0" (152.4 cm)	WL-60B
6'-0" (182.9 cm)	WL-72B

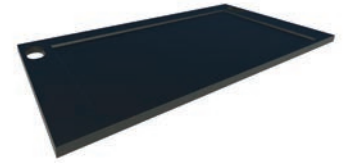

Bench Fume Hood Work Surface Cup Sink Cutout and Cup Sink

- This includes a cup sink cutout and black polypropylene 3" x 6" cup sink
- Bench Fume Hood Work Surface sold separately

For use with:	Sink and Left Side Cutout	Sink and Right Side Cutout
Bench Fume Hood	CS-LS	CS-RS



Adjustable Height Fume Hood Ceiling Enclosure

- These three sided ceiling enclosures are designed to fill the space between the top of the hood and the ceiling up to 24" (61 cm) in height to provide a clean finished appearance.
- The enclosure is cut to fit in the field and includes a slip to fit ceiling finish trim angle.

Fume Hood Width	Part Number
4'-0" (121.9 cm)	CE048P-NA-24GG
5'-0" (152.4 cm)	CE060P-NA-24GG
6'-0" (182.9 cm)	CE072P-NA-24GG



Gravity Sash Stop

- As a safety or energy conservation measure, a sash stop may be added to any of our hoods.
- It may be mounted at any distance above the lower deflector vane to keep the sash from rising past that point.
- When needed, the stop may be pivoted out of the way.

Product	Part Number
Gravity Sash Stop	SP01

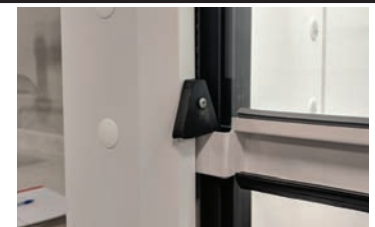

Bench and Wall Shelving



A place for everything and everything in its place



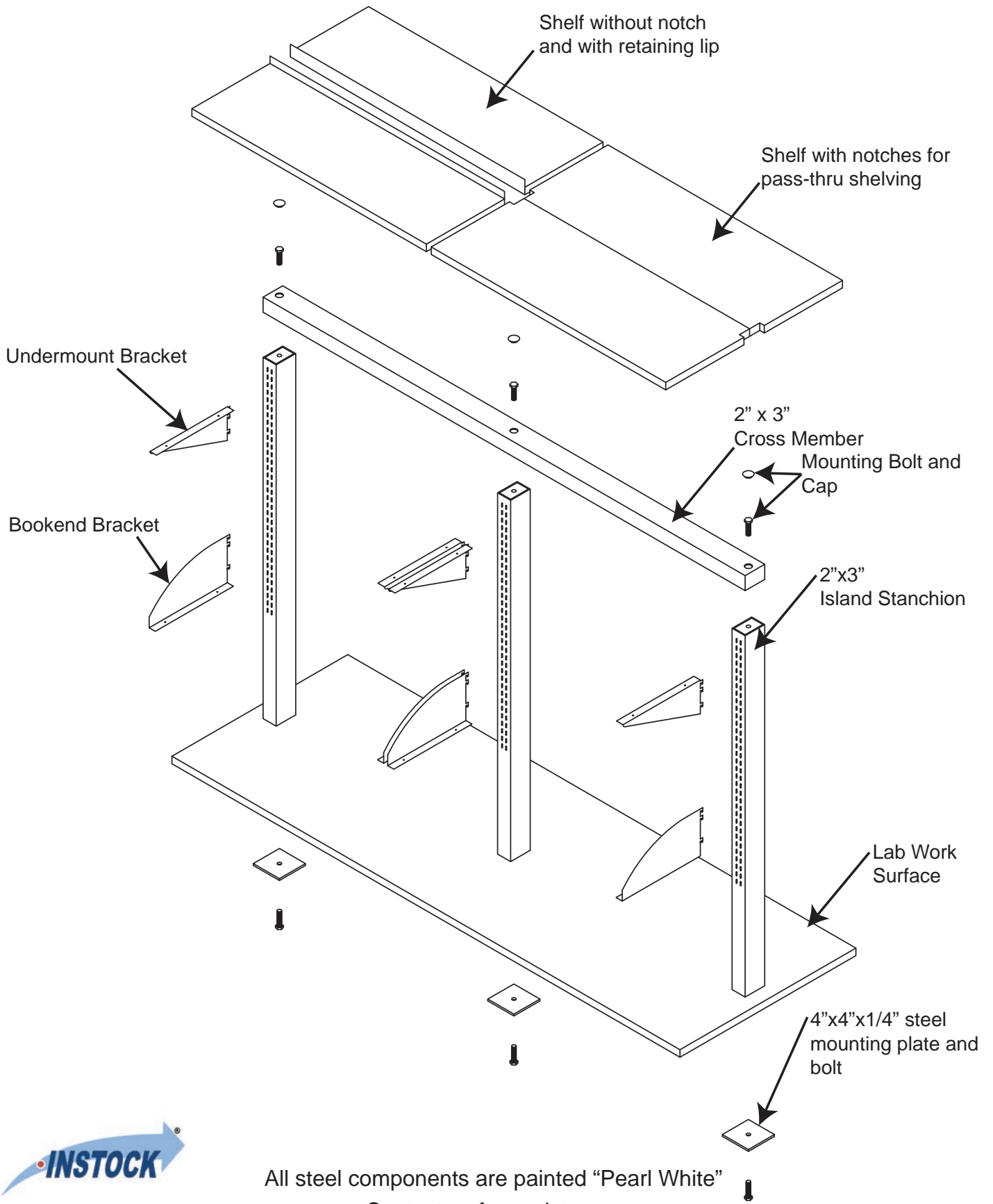

All steel components are painted "Pearl White"
Contact us for assistance.



Island Stanchion

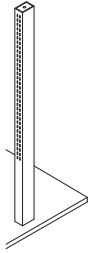

- 48" Tall
- 11 ga.
- All hardware is included

FT-23-4B-48.00A	48" L (121.9 cm)
-----------------	---------------------

Wall Standard



FC-1.5X.5-2B-36.00	36" L (91.4 cm)
FC-1.5X.5-2B-48.00	48" L (121.1 cm)
FC-1.5X.5-2B-60.00	60" L (152.4 cm)
FC-1.5X.5-2B-72.00	72" L (182.9 cm)

Cross Member

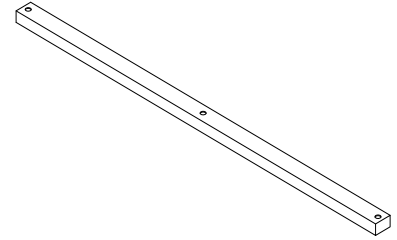

- Cross members are custom made for each project
- Priced in 12" increments
- Welded and caps
- All hardware is included
- Contact us for full details

Bookend Shelf Bracket

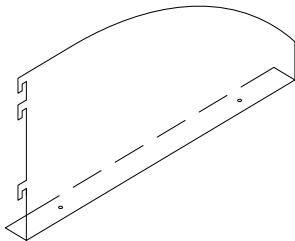

Left Bracket	
FTB-14GA-8L-E	8" D (20.3 cm)
FTB-14GA-12L-E	12" D (30.5 cm)
FTB-14GA-16L-E	16" D (40.6 cm)
Right Bracket	
FTB-14GA-8R-E	8" D (20.3 cm)
FTB-14GA-12R-E	12" D (30.5 cm)
FTB-14GA-16R-E	16" D (40.6 cm)

Undermount Bracket

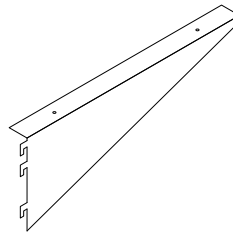

Left Bracket	
FTBL-14GA-8L-E	8" D (20.3 cm)
FTBL-14GA-12L-E	12" D (30.5 cm)
FTBL-14GA-16L-E	16" D (40.6 cm)
Right Bracket	
FTBL-14GA-8R-E	8" D (20.3 cm)
FTBL-14GA-12R-E	12" D (30.5 cm)
FTBL-14GA-16R-E	16" D (40.6 cm)

TUB2X3X24-H	24" W (61 cm)
TUB2X3X36-H	36" W (91.4 cm)
TUB2X3X48-H	48" W (121.9 cm)
TUB2X3X60-H	60" W (152.4 cm)
TUB2X3X72-H	72" W (182.9 cm)
TUB2X3X84-H	84" W (213.4 cm)
TUB2X3X96-H	96" W (243.8 cm)
TUB2X3X108-H	108" W (274.3 cm)
TUB2X3X120-H	120" W (304.8 cm)
TUB2X3X132-H	132" W (335.3 cm)
TUB2X3X144-H	144" W (365.8 cm)

All steel components are painted Pearl White

Notched Shelving for Island Stanchions

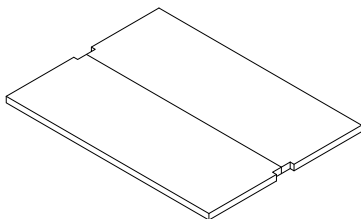

- 1" thick chemical resistant black phenolic resin
- Front edge finished
- Notched around standards to create a pass-thru shelf

8" Deep	12" Deep	16" Deep	Width
PSN0824	PSN1224	PSN1624	24" (61 cm)
PSN0830	PSN1230	PSN1630	30" (76.2 cm)
PSN0836	PSN1236	PSN1636	36" (91.4 cm)
PSN0842	PSN1242	PSN1642	42" (106.7 cm)
PSN0848	PSN1248	PSN1648	48" (121.9 cm)
PSN0854	PSN1254	PSN1654	54" (137.2 cm)
PSN0860	PSN1260	PSN1660	60" (152.4 cm)

Phenolic Shelving

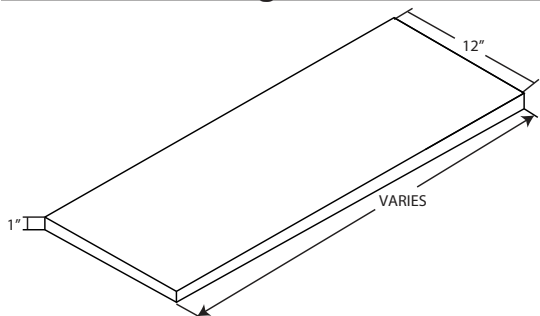

- 1" thick chemical resistant black phenolic resin
- Front edge finished
- **Contact us for custom sizes that can ship in 10 days**

8" Deep	12" Deep	16" Deep	Width
PS0824	PS1224	PS1624	24" (61 cm)
PS0830	PS1230	PS1630	30" (76.2 cm)
PS0836	PS1236	PS1636	36" (91.4 cm)
PS0842	PS1242	PS1642	42" (106.7 cm)
PS0848	PS1248	PS1648	48" (121.9 cm)
PS0854	PS1254	PS1654	54" (137.2 cm)
PS0860	PS1260	PS1660	60" (152.4 cm)

Rear Retaining Lips

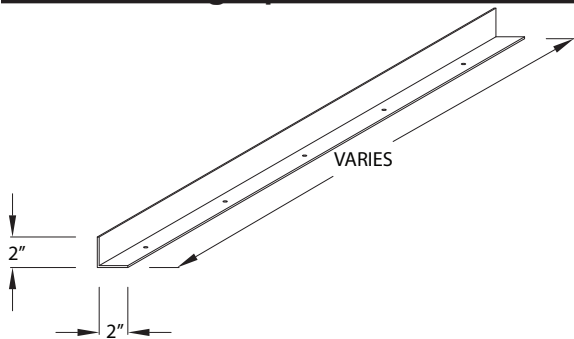

- Provides 1" rear lip for island or peninsula shelving when used with 1" thick shelves
- Attaches to the bottom of shelf
- Holes for attachment spaced at 6" intervals
- Sized to fit shelf
- 16 ga. construction
- Standard color: Pearl White

Painted Steel	Length
PSLA24	24" (61 cm)
PSLA30	30" (76.2 cm)
PSLA36	36" (91.4 cm)
PSLA42	42" (106.7 cm)
PSLA48	48" (121.9 cm)
PSLA54	54" (137.2 cm)
PSLA60	60" (152.4 cm)

Bench Mounted Reagent Poles - Painted



- 1" diameter painted steel pole is threaded at both ends
- Bolts through the work surface for secure mounting
- Poles can stack to create tiered shelves in the center of a bench
- Fastener on the reagent shelf surfaces is recessed
- Hardware is included for each installation
- Standard color: Pearl White

Part Number	Length
RP-12	12" (30.5 cm)
RP-15	15" (38.1 cm)
RP-18	18" (45.7 cm)
RP-24	24" (61 cm)

Shelving Features:

- Chrome wire shelving is made of carbon-steel
- Stainless Steel Units are made of Type 304 Polished Stainless Steel
- Each unit includes: 4 posts, 4 shelves and split-sleeves to attach shelves to posts
- Open wire design minimizes dust accumulation and allows circulation for air
- Shelves can be adjusted at 1" intervals along entire height of the post
- 36"-54" long shelves have a maximum capacity of 800 lbs./each
- 60"-72" long shelves have a maximum capacity of 600 lbs./each
- Each mobile unit has a maximum capacity of 900 lbs., with uniformly distributed load
- Each stationary unit has a maximum capacity of 2,000 lbs., with uniformly distributed load
- Casters: Rubber casters with Poly housing, 5" Swivel, 2 with brake.

Stationary Wire Shelving



Mobile Wire Shelving



Chrome	Stainless Steel	Dimensions W x D x H
J1836-74C	SS1836	36" x 18" x 74" (91.4 x 45.7 x 187.9 cm)
J1848-74C	SS1848	48" x 18" x 74" (121.9 x 45.7 x 187.9 cm)
J1860-74C	SS1860	60" x 18" x 74" (152.4 x 45.7 x 187.9 cm)
J1872-74C	SS1872	72" x 18" x 74" (182.9 x 45.7 x 187.9 cm)
J2436-74C	SS2436	36" x 24" x 74" (91.4 x 61 x 187.9 cm)
J2448-74C	SS2448	48" x 24" x 74" (121.9 x 61 x 187.9 cm)
J2460-74C	SS2460	60" x 24" x 74" (152.4 x 61 x 187.9 cm)
J2472-74C	SS2472	72" x 24" x 74" (182.9 x 61 x 187.9 cm)

Chrome	Stainless Steel	Dimensions W x D x H
MJ1836-79C	MSS1836	36" x 18" x 79" (91.4 x 45.7 x 200.7 cm)
MJ1848-79C	MSS1848	48" x 18" x 79" (121.9 x 45.7 x 200.7 cm)
MJ1860-79C	MSS1860	60" x 18" x 79" (152.4 x 45.7 x 200.7 cm)
MJ1872-79C	MSS1872	72" x 18" x 79" (182.9 x 45.7 x 200.7 cm)
MJ2436-79C	MSS2436	36" x 24" x 79" (91.4 x 61 x 200.7 cm)
MJ2448-79C	MSS2448	48" x 24" x 79" (121.9 x 61 x 200.7 cm)
MJ2460-79C	MSS2460	60" x 24" x 79" (152.4 x 61 x 200.7 cm)
MJ2472-79C	MSS2472	72" x 24" x 79" (182.9 x 61 x 200.7 cm)

Wire Shelf Dividers



- Keep shelf contents orderly with these 8" high, pressure-fit dividers

Chrome	Stainless Steel	Dimensions L x H
JDD18C	DD18S	18" x 8" (45.7 x 20.3 cm)
JDD24C	DD24S	24" x 8" (61 x 20.3 cm)

Wire Super Slide

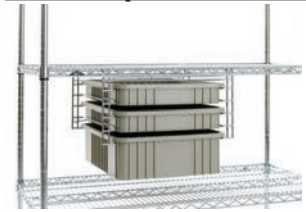

- Finish is nickel-chrome wire with clean protective coating
- Only for 24" deep units

Part Number	Dimensions H x W x L
SS2NC	10 1/4" x 20 3/8" x 21 5/8" (26 x 52.3 x 54.9 cm)
Hanging Totes	
MTB93030W	3" x 17 1/2" x 22 1/2" (7.6 x 44.5 x 57.2 cm)
MTB93060W	6" x 17 1/2" x 22 1/2" (15.2 x 44.5 x 57.2 cm)
MTB93080W	8" x 17 1/2" x 22 1/2" (20.3 x 44.5 x 57.2 cm)

Wire Shelf Ledges

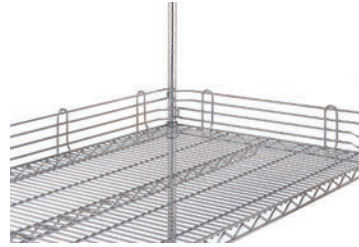

- For stationary or mobile installations
- Ledges prevent items from protruding or falling from shelves

Chrome	Stainless Steel	Dimensions L x H
JL18N-4C	L18N-4S	18" x 4" (45.7 x 10.2 cm)
JL24N-4C	L24N-4S	24" x 4" (61 x 10.2 cm)
JL36N-4C	L36N-4S	36" x 4" (91.4 x 10.2 cm)
JL48N-4C	L48N-4S	48" x 4" (121.9 x 10.2 cm)
JL60N-4C	L60N-4S	60" x 4" (152.4 x 10.2 cm)
JL72N-4C	L72N-4S	72" x 4" (182.9 x 10.2 cm)

Clear Label Holders



- Clear plastic label
- Holds most commercial 1 1/4" labels

Part Number	Fits Shelf Length	Dimensions W x H
9990CL	All	3" x 1 1/4" (7.6 x 3.2 cm)
9990CL1	18"	13" x 1 1/4" (33 x 3.2 cm)
9990CL2	24"	19" x 1 1/4" (48.3 x 3.2 cm)
9990CL3	30"	25" x 1 1/4" (63.5 x 3.2 cm)
9990CL4	48"	43" x 1 1/4" (109.2 x 3.2 cm)
9990CL5	60"	55" x 1 1/4" (139.7 x 3.2 cm)

Epoxy Coated Shelving Features:

- Each unit includes 4 posts, 4 shelves and split-sleeves to attach shelves to posts
- Furnished in Metroseal 3 Epoxy
- Corrosion resistant finish for wet or high humidity environments
- Open wire design minimizes dust accumulation and allows free circulation for air
- Shelves can be adjusted at 1" intervals along entire height of the post
- 36"-54" long shelves have a maximum capacity of 800 lbs./each
- 60"-72" long shelves have a maximum capacity of 600 lbs./each
- Each mobile unit has a maximum capacity of 900 lbs., with uniformly distributed load
- Each stationary unit has a maximum capacity of 2,000 lbs., with uniformly distributed load
- 7 year limited warranty against rust and corrosion
- Unit Casters: Rubber casters with Poly housing, 5" Swivel, 2 with brake.

Epoxy Coated Stationary Wire Shelving



Epoxy Coated Mobile Wire Shelving



Epoxy Coated	Dimensions W x D x H
J1836-74K	36" x 18" x 74" (91.4 x 45.7 x 187.9 cm)
J1848-74K	48" x 18" x 74" (121.9 x 45.7 x 187.9 cm)
J1860-74K	60" x 18" x 74" (152.4 x 45.7 x 187.9 cm)
J1872-74K	72" x 18" x 74" (182.9 x 45.7 x 187.9 cm)
J2436-74K	36" x 24" x 74" (91.4 x 61 x 187.9 cm)
J2448-74K	48" x 24" x 74" (121.9 x 61 x 187.9 cm)
J2460-74K	60" x 24" x 74" (152.4 x 61 x 187.9 cm)
J2472-74K	72" x 24" x 74" (182.9 x 61 x 187.9 cm)

Epoxy Coated	Dimensions W x D x H
MJ1836-79K	36" x 18" x 79" (91.4 x 45.7 x 200.7 cm)
MJ1848-79K	48" x 18" x 79" (121.9 x 45.7 x 200.7 cm)
MJ1860-79K	60" x 18" x 79" (152.4 x 45.7 x 200.7 cm)
MJ1872-79K	72" x 18" x 79" (182.9 x 45.7 x 200.7 cm)
MJ2436-79K	36" x 24" x 79" (91.4 x 61 x 200.7 cm)
MJ2448-79K	48" x 24" x 79" (121.9 x 61 x 200.7 cm)
MJ2460-79K	60" x 24" x 79" (152.4 x 61 x 200.7 cm)
MJ2472-79K	72" x 24" x 79" (182.9 x 61 x 200.7 cm)

Choose the right lab work surface to complete your project

Our **INSTOCK** work surfaces include epoxy resin and phenolic. These materials are special ordered to meet specific size and space requirements. These work surfaces ship in 7 days.

Work surfaces can be ordered in different depths, with special edge details, with extra high backsplashes, or a variety of cutouts. One of our Furniture Specialists can assist you in selecting the correct work surface material and style to meet your particular needs.

Custom Manufactured Work Surfaces

We offer custom laboratory work surfaces in 1" thick black epoxy and black phenolic. These custom quick ship work surfaces are designed and engineered to suit your specific needs. Use the part numbers below as a reference point. Contact us for assistance.

Black Epoxy	Black Phenolic	Unit
CMWSSF-E	CMWSSF-P	Per Square Foot
CMWSSC-E	CMWSSC-P	Sink Cutout
CMWSB-E	CMWSB-P	Fixture Boring or Cutout

Mixing Faucets

- Mixing faucets are deck-mounted and have an option for a vacuum breaker
- They come with four-arm or blade handles
- They are chrome plated brass with an 8" swivel gooseneck
- Valves are self-contained units with replaceable stainless steel seats

Four-arm Handle with Vacuum Breaker



Part Number	Type
L412-8VB	Four-arm handle with vacuum breaker

Four-arm Handle without Vacuum Breaker



Part Number	Type
L412-8	Four-arm handle without vacuum breaker

Blade Handle with Vacuum Breaker



Part Number	Type
L412-8VB-BH	Blade handle with vacuum breaker

Blade Handle without Vacuum Breaker



Part Number	Type
L412-8-BH	Blade handle without vacuum breaker

Cold Water Faucets

- Cold water faucets are deck-mounted and have an option for a vacuum breaker.
- They come with a four arm or blade handle
- They are chrome plated brass with an 8" swivel gooseneck
- Valves are self-contained units with replaceable stainless steel seats

Four-arm Handle with Vacuum Breaker



Part Number	Type
L611-8VB	Four-arm handle with vacuum breaker

Four-arm Handle without Vacuum Breaker



Part Number	Type
L611-8	Four-arm handle without vacuum breaker

Blade Handle with Vacuum Breaker



Part Number	Type
L611-8VB-BH	Blade handle with vacuum breaker

Blade Handle without Vacuum Breaker



Part Number	Type
L611-8-BH	Blade handle without vacuum breaker

Foot Operated Faucet



- Foot operated faucet is deck mounted with a vacuum breaker.
- Faucet is chrome plated brass with 8" swivel gooseneck.
- Valves are self-contained units with replaceable stainless steel seats.
- Faucet has a floor mounted foot operated valve.

Part Number	Type
L084-8-3001-BH	Foot operated with vacuum breaker

DI/RO Faucet



- DI/RO faucet is deck mounted for distilled, deionized or reverse osmosis water.
- Faucet with a 6" spread and has exterior brass casing and interior lining of inert polypropylene.
- Faucet has a diaphragm-type valve.
- The handle is a nylon toggle-style lever and a combination manual/self-closing

Part Number	Type
L7833MSC	DI/RO

Aerator



- This aerator is 3/8" NPS male inlet.
- It replaces a serrated hose end and most faucets.

Part Number	Type
BO055	Aerator

Laboratory Ball Valves

- Laboratory Ball Valves are deck mounted turret base
- They are chrome plated brass
- It is quarter-turn open/close.
- The lever is forged brass with color-coded index button/cap.

One Turret

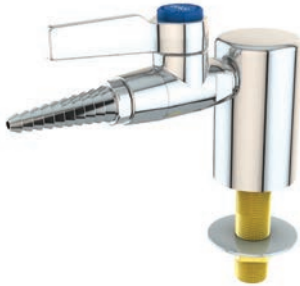

Part Number	Service
L4200-131WSA-G	Gas
L4200-131WSA-A	Air
L4200-131WSA-N	Nitrogen
L4200-131WSA-V	Vacuum

Two Turrets, 90°

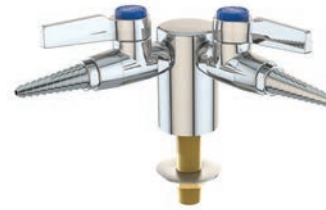

Part Number	Service
L4200-132AWSA-G	Gas
L4200-132AWSA-A	Air
L4200-132AWSA-N	Nitrogen
L4200-132AWSA-V	Vacuum

Two Turrets, 180°



Part Number	Service
L4200-132SWSA-G	Gas
L4200-132SWSA-A	Air
L4200-132SWSA-N	Nitrogen
L4200-132SWSA-V	Vacuum

Four Turrets



Part Number	Service
L4200-134WSA-G	Gas
L4200-134WSA-A	Air
L4200-134WSA-N	Nitrogen
L4200-134WSA-V	Vacuum

Eyewash



- Eyewash mounts on counter next to a sink.
- It swivels 90°
- Water flow is activated by flag handle.
- Each head has a flip open dust cover.
- The eyewash is chrome plated brass.

Part Number	Type
EW806	Right Hand Mounting
EW806LH	Left Hand Mounting

Low Profile Eyewash



- Eyewash mounts on counter next to a sink.
- It swivels 90°
- Water flow is activated by swinging the spray head over sink.
- Each head has a flip open dust cover.
- The eyewash is chrome plated brass.

Part Number	Type
EW805	Right Hand Mounting
EW805LH	Left Hand Mounting

Eyewash/Drench Hose



- Deck mounted dual purpose eyewash/drench hose.
- Water flow is activated by stainless steel lever handle.
- A back flow preventer is included on the inlet of the supply hose.
- Each head has a flip open dust cover.

Part Number	Type
EW1022BP	Eyewash/Drench Hose

Drench Shower/Eyewash



- Free-standing drench shower made of orange ABS plastic.
- Ball valve operated by a rigid pull rod and easy grip handle.
- Eyewash fixture with stainless steel bowl is provided with four gentle spray heads and a “Push to Operate” ball valve.
- Eyewash and shower operated independently.
- Overall height is 80”

Part Number	Type
SS909	Drench Shower/Eyewash

ADA Drench Shower/Eyewash



- Free-standing drench shower made of orange ABS plastic.
- Ball valve operated by a rigid pull rod and easy grip handle.
- Eye wash fixture with stainless steel bowl is provided with four gentle spray heads and a “Push to Operate” ball valve.
- Eyewash and shower operated independently.
- Overall height is 80”.
- Unit complies with ADA requirements for accessibility by handicapped persons (maximum height and reach, minimum knee clearance and distance from obstructions).

Part Number	Type
SSBF909	Drench Shower

Drench Shower



- Emergency shower head assembly is wall mounted.
- It includes a 10” diameter orange ABS plastic shower head.
- Operated by a rigid pull-rod and easy to grip handle.

Part Number	Type
ES643	Drench Shower

Stainless Steel Pegboard

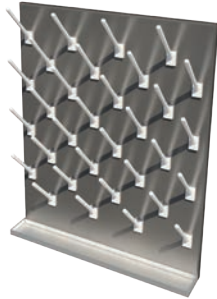

- This pegboard is made of Type 304 stainless steel pegboard with 1/2" diameter, 6" long white polypropylene pegs
- Pegboard is 30" tall and is furnished with a 4" wide stainless steel drip trough and clear plastic drain tube.

Part Number	Number of Pegs	Dimensions
V2430	32	24" W x 30" H (61 x 76.2 cm)
V3630	60	36" W x 30" H (91.4 x 76.2 cm)
with Finished Back		
V2430FB	32	24" W x 30" H (61 x 76.2 cm)
V3630FB	60	36" W x 30" H (91.4 x 76.2 cm)

Phenolic Resin Pegboard



- This pegboard is made of black phenolic resin with 6" long black polypropylene pegs and a finished back.
- Pegboard is 30" tall and is furnished with a 4" wide stainless steel drip trough and clear plastic drain tube.

Part Number	Number of Pegs	Dimensions
PB-PR2430	39	24" W x 30" H (61 x 76.2 cm)
PB-PR3030	46	30" W x 30" H (76.2 x 76.2 cm)

Drop-In Epoxy Resin Sinks

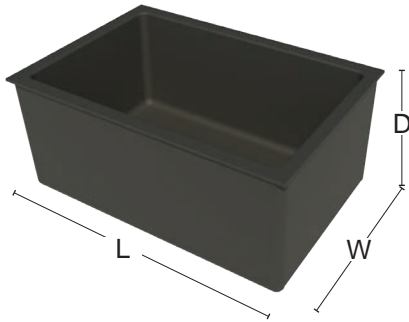

- These durable black epoxy sinks are chemically resistant, come with coved corners and are pitched to a corner or center drain.
- All tub sinks are furnished complete with a tail piece and strainer.
- Drop in sinks can be converted to be undermount sinks, however cabinet sink supports will be required.

Part Number	Dimensions (L x W x D)	Outlet
D-30	18" x 15" x 11" (45.7 x 38.1 x 27.9 cm)	Center
D-50	24" x 16" x 8" (61 x 40.6 x 20.3 cm)	Center
D-55	25" x 15" x 10" (63.5 x 38.1 x 25.4 cm)	Corner
D-59	28" x 15" x 11.8" (71.1 x 38.1 x 30 cm)	Corner
A-55 (ADA Sink)	25" x 15" x 4.8" (63.5 x 38.1 x 12.2 cm)	Corner

Cup Sink



- This cup sink is of black polypropylene construction.
- Sink is a drop in and includes strainer, cap and drain pipe.

Part Number	Dimensions (L x W x D)	Outlet
LB-U04	6" x 3" x 3.7" (15.2 x 7.6 x 9.4 cm)	Center

Drop-In Stainless Steel Sinks



- These stainless steel sinks are of a seamless die-drawn construction of 18 gauge, Type 304 stainless steel.
- Interior surfaces are polished to a non-porous finish.
- The underside is fully coated and insulated for sound deadening and reduced condensation.
- Self-rimming top mount with stainless steel mounting channels.
- The sink bottoms are pitched to a center drain.
- Crumb strainer and tail piece included.

Part Number	Dimensions (L x W x D)
S-1721-A-GR	21" x 17" x 7.5" (53.3 x 43.2 x 19.1 cm)
S-1925-A-GR	25" x 19" x 7.5" (63.5 x 48.3 x 19.1 cm)
SX-1925-A-GR	25" x 19" x 10.5" (63.5 x 48.3 x 26.7 cm)

Undermount Stainless Steel



- These stainless steel sinks are of a seamless die-drawn construction of 18 gauge, Type 304 stainless steel.
- Interior surfaces are polished to a non-porous finish.
- The underside is fully coated and insulated for sound deadening and reduced condensation.
- The sink bottoms are pitched to a center drain.
- Crumb strainer and tail piece included.
- Sink support required and ordered separately.

Part Number	Dimensions (L x W x D)
USX-1618-A	18" x 16" x 10.5" (45.7 x 40.6 x 26.7 cm)
US-1824-A	24" x 18" x 7.5" (61 x 45.7 x 19.1 cm)
USX-1824-A	24" x 18" x 10.5" (61 x 45.7 x 26.7 cm)
USX-1830-A	30" x 18" x 10.5" (76.2 x 45.7 x 26.7 cm)

Single Gang Electrical Pedestal



- This unit is single gang, double faced.
- It is 120 V and 20 amp.
- Supplied with black outlets and stainless steel cover plates.
- The box is cast aluminum and is powder coated with a black textured epoxy finish.

Part Number	Type
E433WS	Standard Outlets
E433WS-GFI	GFI Outlets

Double Gang Electrical Pedestal



- This unit is double gang, double faced.
- It is 120 V and 20 amp.
- Supplied with black outlets and stainless steel cover plates.
- The box is cast aluminum and is powder coated with a black textured epoxy finish.

Part Number	Type
E633WS	Standard Outlets
E633WS-GFI	GFI Outlets

Custom Electrical Pedestal

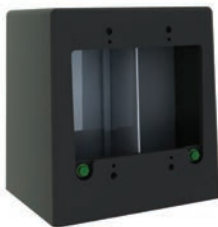

- This electrical pedestal is double faced and can accommodate a variety of styles and configurations.
- As many as 4 duplex outlets can be installed.
- The chambered design minimizes RF interference when combining electrical and data outlets in this fixture.
- Outlets and cover plates supplied separately.
- The box is cast aluminum and is powder coated with a black textured epoxy finish.

Part Number	Type
E800WS	Custom

Customizable Seating

Select from thousands of seating options, including chairs specifically designed for laboratory, clean room and ESD applications. Select the height, materials, features and colors that are most appropriate for your specific tasks or environment. Ergonomics are critical, so our chairs and stools are designed to allow user to make adjustments to seats and backs and to add arms and foot rings where appropriate to provide optimal comfort and support.

Laboratory



Industrial



Garment Racks - Stainless Steel



Upright

- Electro-polished, Type 304 Stainless Steel hangers are included. Hangers are spaced 3" (7.6 cm) intervals
- Open wire construction promotes laminar air flow
- Unique hanger capture mechanism provides theft deterrence
- Easy to assemble
- Adjustable stainless steel triangular foot plates provided for floor mounting
- Upright unit is non-conductive.

Wall Mount	Upright	Dimensions W x D	Number of Hangers
GRW2436S	GRU2436S	36" x 24" (91.4 x 61 cm)	11
GRW2448S	GRU2448S	48" x 24" (121.9 x 61 cm)	15



Wall Mount

Gowning Bench - Stainless Steel



- Heavy-duty, solid top bench provides a sturdy and comfortable gowning fixture. All benches are 18" (45.7 cm) tall
- Top is manufactured from 14 gauge, Type 304 stainless steel
- Adjustable stainless steel foot plates provided for floor mounting
- Unit is non-conductive

Part Number	Dimensions W x D
GB1636S	36" x 16" (91.4 x 40.6 cm)
GB1648S	48" x 16" (121.9 x 40.6 cm)
GB1660S	60" x 16" (152.4 x 40.6 cm)
GB1672S	72" x 16" (182.5 x 40.6 cm)

MetroMax Utility Cart



Three Shelf Model

- Corrosion proof shelves, posts and Type 304 stainless steel handle
- 5" (12.7 cm) swivel casters, polyurethane wheels, poly housing and stainless steel axles
- Donut bumpers included with casters
- Furnished complete as a 2 shelf or 3 shelf unit

Part Number	Description	Dimensions W x D x H
MXUC1830-25	2 Shelves	18" x 30" x 39" (45.7 x 76.2 x 99.1 cm)
MXUC2436-25	2 Shelves	24" x 36" x 39" (61 x 91.4 x 99.1 cm)
MXUC1830-35	3 Shelves	18" x 30" x 39" (45.7 x 76.2 x 99.1 cm)
MXUC2436-35	3 Shelves	24" x 36" x 39" (61 x 91.4 x 99.1 cm)

Security Units

- Durable chrome finish will not chip or flake
- Double doors each open 270° and can be secured along the sides of the unit
- Mobile units (4) 5" polyurethane swivel casters with bumpers
- Unit comes with top and bottom shelves and 2 internal wire shelves.
- Stationary Units are 67" tall. Mobile units are 68" tall.



Stationary Unit



Mobile Unit

Part Number	Dimensions W x D x H
JSEC53	36" x 24" x 67" (91.4 x 61 x 170.2cm)
JSEC55	48" x 24" x 67" (121.9 x 61 x 170.2 cm)
JSEC56	60" x 24" x 67" (152.4 x 61 x 170.2 cm)

Part Number	Dimensions W x D x H
MJSEC53	36" x 24" x 68" (91.4 x 61 x 172.7 cm)
MJSEC55	48" x 24" x 68" (121.9 x 61 x 172.7 cm)
MJSEC56	60" x 24" x 68" (152.4 x 61 x 172.7 cm)

Deep Ledge Polymer Utility Cart



- Specially designed with a 2 3/4" deep ledge to contain product and spills
- Polymer shelves are easy to clean and corrosion proof
- On units with 3 shelves the center shelf adjusts at 1" increments
- Weight capacity is 400 lbs
- Blue units have built-in Microban antimicrobial product protection

Grey	Black	Blue	Dimensions W x D x H
2 Shelves			
BC2030-2DG	BC2030-2DBL	BC2030-2DMB	21 1/2" x 33 3/4" x 33 1/4" (54.6 x 85.7 x 84.5 cm)
BC2636-2DG	BC2636-2DBL	BC2636-2DMB	27" x 39 1/2" x 33 1/4" (68.5 x 100.3 x 84.5 cm)
3 Shelves			
BC2030-3DG	BC2030-3DBL	BC2030-3DMB	21 1/2" x 33 3/4" x 33 1/4" (54.6 x 85.7 x 84.5 cm)
BC2636-3DG	BC2636-3DBL	BC2636-3DMB	27" x 39 1/2" x 33 1/4" (68.5 x 100.3 x 84.5 cm)

Polymer Utility Cart



- Each cart comes with two labels for easy identification
- All-polymer shelves will never corrode
- Impact resistant shelves are designed to withstand daily abuse
- 7/16" (1.1 cm) shelf's edge retains small spills and prevents items from sliding off during transport
- Blue units have built-in Microban antimicrobial product protection

Grey	Black	Blue	Dimensions W x L x H
2 Shelves			
MY1627-24G	MY1627-24BL	MY1627-24BU	18 5/16" x 31 1/2" x 35 1/2" (46.5 x 80 x 90.2 cm)
MY2030-24G	MY2030-24BL	MY2030-24BU	23 7/16" x 34 3/8" x 35 1/2" (59.5 x 87.3 x 90.2 cm)
MY2636-25G	MY2636-25BL	MY2636-25BU	27 11/16" x 40 1/4" x 36 7/8" (70.3 x 102.2 x 93.7 cm)
3 Shelves			
MY1627-34G	MY1627-34BL	MY1627-34BU	18 5/16" x 31 1/2" x 35 1/2" (46.5 x 80 x 90.2 cm)
MY2030-34G	MY2030-34BL	MY2030-34BU	23 7/16" x 34 3/8" x 35 1/2" (59.5 x 87.3 x 90.2 cm)
MY2636-35G	MY2636-35BL	MY2636-35BU	27 11/16" x 40 1/4" x 36 7/8" (70.3 x 102.2 x 93.7 cm)

Stainless Steel Work Tables with Bottom Shelf



- Seamless 14 gauge Type 304 stainless steel work surface and support structure
- Stationary work tables are 34" tall with stationary posts and leveling feet

Part Number	Dimensions D x L x H
WT305FS	30" x 48" x 34" (76.2 x 121.9 x 76 cm)
WT306FS	30" x 60" x 34" (76.2 x 152.4 x 76 cm)
WT307FS	30" x 72" x 34" (76.2 x 182.9 x 76 cm)
WT309FS	30" x 96" x 34" (76.2 x 243.8 x 76 cm)
WT366FS	36" x 60" x 34" (91.4 x 152.4 x 76 cm)
WT367FS	36" x 72" x 34" (91.4 x 182.9 x 76 cm)
WT369FS	36" x 96" x 34" (91.4 x 243.8 x 76 cm)
WT446FS	44" x 60" x 34" (111.8 x 152.4 x 76 cm)
WT447FS	44" x 72" x 34" (111.8 x 182.9 x 76 cm)
WT449FS	44" x 96" x 34" (111.8 x 243.8 x 76 cm)

Stainless Steel Work Tables with 3-sided Frame



- Seamless 14 gauge Type 304 stainless steel work surface and support structure
- Stationary work tables are 34" tall with stationary posts and leveling feet

Part Number	Dimensions D x L x H
WT305US	30" x 48" x 34" (76.2 x 121.9 x 76 cm)
WT306US	30" x 60" x 34" (76.2 x 152.4 x 76 cm)
WT307US	30" x 72" x 34" (76.2 x 182.9 x 76 cm)
WT309US	30" x 96" x 34" (76.2 x 243.8 x 76 cm)
WT366US	36" x 60" x 34" (91.4 x 152.4 x 76 cm)
WT367US	36" x 72" x 34" (91.4 x 182.9 x 76 cm)
WT369US	36" x 96" x 34" (91.4 x 243.8 x 76 cm)
WT446US	44" x 60" x 34" (111.8 x 152.4 x 76 cm)
WT447US	44" x 72" x 34" (111.8 x 182.9 x 76 cm)
WT449US	44" x 96" x 34" (111.8 x 243.8 x 76 cm)

Mobile Stainless Steel Work Tables



- Seamless 14 gauge Type 304 stainless steel work surface and support structure
- Mobile work tables are 34" tall with special posts and 4 poly casters (2 swivel/2 brake)

Part Number	Dimensions D x L x H
MWT305US	30" x 48" x 34" (76.2 x 121.9 x 76 cm)
MWT306US	30" x 60" x 34" (76.2 x 152.4 x 76 cm)
MWT307US	30" x 72" x 34" (76.2 x 182.9 x 76 cm)
MWT309US	30" x 96" x 34" (76.2 x 243.8 x 76 cm)

Balance Table



- Balance tables provide a stable and vibration resistant workspace for sensitive procedures
- Work top is 2" thick
- Top, sides and middle supports are all constructed from epoxy black resin material

Part Number	Dimensions W x D x H
BT3624	36" x 24" x 30" (91.4 x 61 x 76.2 cm)
BT4824	48" x 24" x 30" (121.9 x 61 x 76.2 cm)

Electrical Wire Raceways



- Pre-wired single channel aluminum wire raceway with 120V, 20 amp, standard outlets or with 120V, 20 amp, GFI outlets.
- Includes 8' black power cord with plug.
- Power plug available as NEMA 5-20P straight blade or NEMA L5-20 twist-to-lock

Raceway Length	Number of Outlets	GFCI Outlets with Straight Blade Plug	GFCI Outlets with Twist-to-Lock Plug	Standard Outlet with Straight Blade Plug	Standard Outlet with Twist-To-Lock Plug
48" (121.9 cm)	4	EWR48GFI-S	EWR48GFI-T	EWR48-S	EWR48-T
60" (152.4 cm)	6	EWR60GFI-S	EWR60GFI-T	EWR60-S	EWR60-T
72" (182.9 cm)	6	EWR72GFI-S	EWR72GFI-T	EWR72-S	EWR72-T
84" (213.4 cm)	8	EWR84GFI-S	EWR84GFI-T	EWR84-S	EWR84-T
96" (243.8 cm)	8	EWR96GFI-S	EWR96GFI-T	EWR96-S	EWR96-T

Task Lighting



- Features multiple, state of the art, energy saving components that include touch and hold continuous dimming and 10-hour automatic turnoff.
- Made with anodized aluminum and lasts up to 50,000 hours.
- **Starter Units** include 1 ea LED task light, magnetic angle mount that allows for up to 25 degrees of adjustment, 60 watt power supply with magnetic mount and 6' white cord.
- **Add On** units include 1 ea LED task light, magnetic angle mount and 1 ea interlink cord to connect to Starter Unit.
- Units for use with phenolic shelves will include a painted metal strip to attach to underside of the phenolic shelf to receive the magnet mounts.

Part Number		Actual Width of Light	For Use with
Starter Unit	Add On Unit		
LED-36S	LED-36AO	23.3" (59.2 cm)	36" Wide Metal Cabinet
LED-48S	LED-48AO	30.1" (76.5 cm)	48" Wide Metal Cabinet
LED-24S	LED-24AO	16.4" (41.7 cm)	24" Wide Phenolic Shelf
LED-3036S	LED-3036AO	23.3" (59.2 cm)	30" or 36" Wide Phenolic Shelf
LED-4248S	LED-4248AO	30.1" (76.5 cm)	42" or 48" Wide Phenolic Shelf
LED-60S	LED-60AO	43.7" (111 cm)	60" Wide Phenolic Shelf

Chase Support Assembly



- An adjustable height floor mounted, support assembly for work surfaces as well as drain line and a plumbing chase for piping

Part Number	Dimensions H x D
CSA3108	27"-31" x 8" (68.6-78.7 x 20.3 cm)
CSA3708	33"-37" x 8" (83.8-94 x 20.3 cm)

Cabinet Base Molding



- Base molding is installed directly on the toe-kick of a base cabinet and is the final step in installing a lab to create a finished look
- The base molding has a self-adhesive back for easy application

Part Number	Dimensions H x L
VBM48	4" x 48" (10.2 x 121.9 cm)

Wall Mounted Cylinder Restraints



- Cast aluminum, wall mounted cylinder restraint
- Includes mounting hardware and a nylon strap
- The restraints can be placed adjacent to each other to secure a group of cylinders

Part Number	Cylinder Diameter
CRWM	4"-14" (10.2 - 35.6 cm)

Free Standing Cylinder Restraints

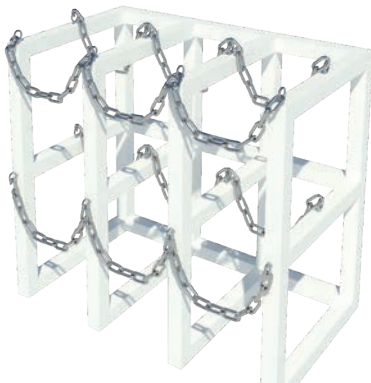

- The free standing cylinder restraint is constructed from 2" x 2" tubular steel
- A fully welded design provides for the proper restraint of cylinders
- Includes security chains

Part Number	Number of Cylinders	Dimensions W x D x H
CRFM2X1 (2 Cylinders x 1 bay)	2	30" x 16" x 30" (76.2 x 40.6 x 76.2 cm)
CRFM2X2 (2 Cylinders x 2 bay)	4	30" x 32" x 30" (76.2 x 81.3 x 76.2 cm)
CRFM2X3 (2 Cylinders x 3 bay)	6	30" x 48" x 30" (76.2 x 121.9 x 76.2 cm)
CRFM3X1 (3 Cylinders x 1 bay)	3	45" x 16" x 30" (114.3 x 40.6 x 76.2 cm)
CRFM3X2 (3 Cylinders x 2 bay)	6	45" x 32" x 30" (114.3 x 81.3 x 76.2 cm)
CRFM3X3 (3 Cylinders x 3 bay)	9	45" x 48" x 30" (114.3 x 121.9 x 76.2 cm)



SOUTHWEST**SOLUTIONS**GROUP

We Make Space & People Work Better Together

Emergency Response Furnishings

