

Modular Casework Budget Per Linear Foot

(GreenGuard Certified for LEED Projects)

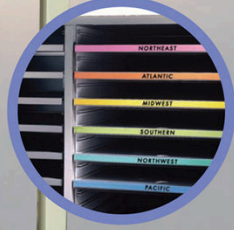

Quality, concealed hinges are invisible from the outside of the cabinet for a smooth, uninterrupted door aesthetic.



Hamilton's unique shelving systems provides shelf adjustability in 1" increments.



Shelves feature full width, color coded labeling for quick, accurate sorting.



Our easy-to-install, rail-mounted wall cabinets provide precise height and depth adjustment for clean installation and the look of custom millwork.



Leveling system assures perfect alignment of modular components.



Choose from our selection of standard handles, or we can match your custom specifications.



We seal all edges with impact-resistant PVC for durability; there are no exposed edges on our caseworks.



Full-extension ball-bearing slides provide a lifetime of smooth operation.

CAD TEMPLATES AND REVIT BIM LIBRARY AVAILABLE FOR THE ENTIRE PRODUCT LINE. CABINETS ARE CLASSIFIED AND DEPRECIATED AS FURNITURE.

SOUTHWEST SOLUTIONS GROUP
business organization systems
www.southwestsolutions.com/casework
Toll Free 1-800-803-1083

AVAILABLE ON THE FOLLOWING CONTRACTS:





Modular Casework Budget Per Linear Foot

(GreenGuard Certified for LEED Projects)

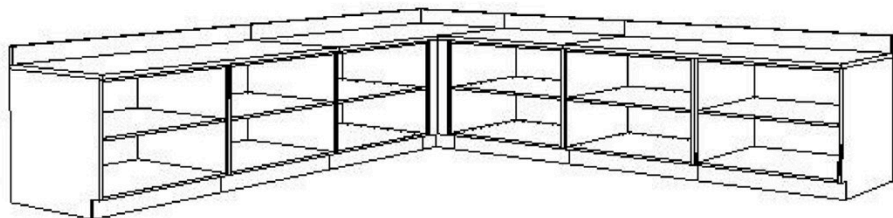
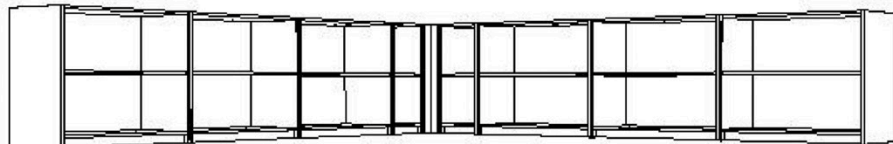

OPEN CABINETS

Delivered and installed (worst case budget) \$375.00 per linear foot. All pricing includes open upper cabinets, open lower cabinets, and counter tops in a Wilsonart standard finish (see standard color offering).

REVIT BIM LIBRARY AVAILABLE FOR THE ENTIRE PRODUCT LINE

CLOSED CABINETS

Delivered and installed (worst case budget) \$460.00 per linear foot. All pricing includes closed upper cabinets, closed lower cabinets, and counter tops in a Wilsonart standard finish (see standard color offering).

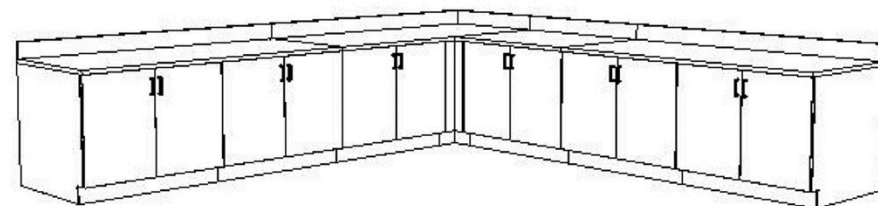
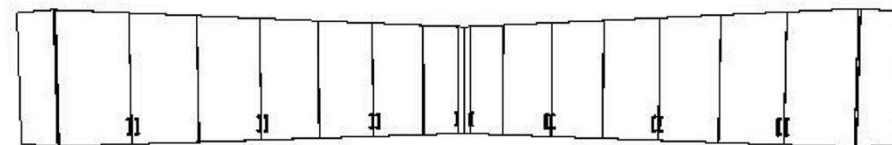

CAD TEMPLATES AVAILABLE FOR THE ENTIRE PRODUCT LINE

MIXED CABINETS

Delivered and installed (worst case budget) \$571.00 per linear foot. All pricing includes upper cabinets, lower cabinets, adjustable mail slots, rolled plan storage slots, drawers, forms storage, full corner cabinet, and counter tops in a Wilsonart standard finish (see standard color offering).

OUR PRODUCT IS CLASSIFIED AND DEPRECIATED AS FURNITURE

